

| SNO. | SYMBOL | DESCRIPTION |
|------|--------|--|
| 01. | ① | 110 OD SOIL PIPE |
| 02. | ② | 110 OD WASTE PIPE |
| 03. | ③ | 75 OD ANTI-SIPHONAGE PIPE |
| 04. | ④ | DWS-DOMESTIC WATER SUPPLY PIPE |
| 05. | ⑤ | FWS-FLUSHING WATER SUPPLY PIPE |
| 06. | ⑥ | 160 OD TERRACE RAIN WATER PIPE |
| 07. | ⑦ | 110 OD MENTY & BALCONY RAIN WATER PIPE |
| 08. | ⑧ | DOMESTIC WATER RISER TO G.H. TANK FROM WTP |
| 09. | ⑨ | FLUSHING WATER RISER TO G.H. TANK FROM WTP |
| 10. | ⑩ | SOFT WATER RISER TO G.H. TANK FROM STP |
| 11. | ⑪ | 110 OD BASEMENT DRAIN PIPE |
| 12. | FD | FLOOR DRAIN |
| 13. | FT | FLOOR TRAP |
| 14. | UT | URINAL TRAP |
| 15. | COP | FLOOR CLEAN OUT |
| 16. | — | SOIL PIPE |
| 17. | — | WASTE PIPE |
| 18. | — | FLUSHING WATER SUPPLY(GRAVITY SUPPLY) |
| 19. | — | DOMESTIC WATER SUPPLY(GRAVITY SUPPLY) |

Checked and Found fit for Public Health
 (Checked) (Sealed) (Sealed) (Sealed)
 (Sealed) (Sealed) (Sealed) (Sealed)
 HSE/PA/CH/ADHO

Chairman
 Member Secretary
 BPC
 BPC
 BPC

ADHO
 ADHO
 ADHO

DLF49940

KEY PLAN BUILDING - C

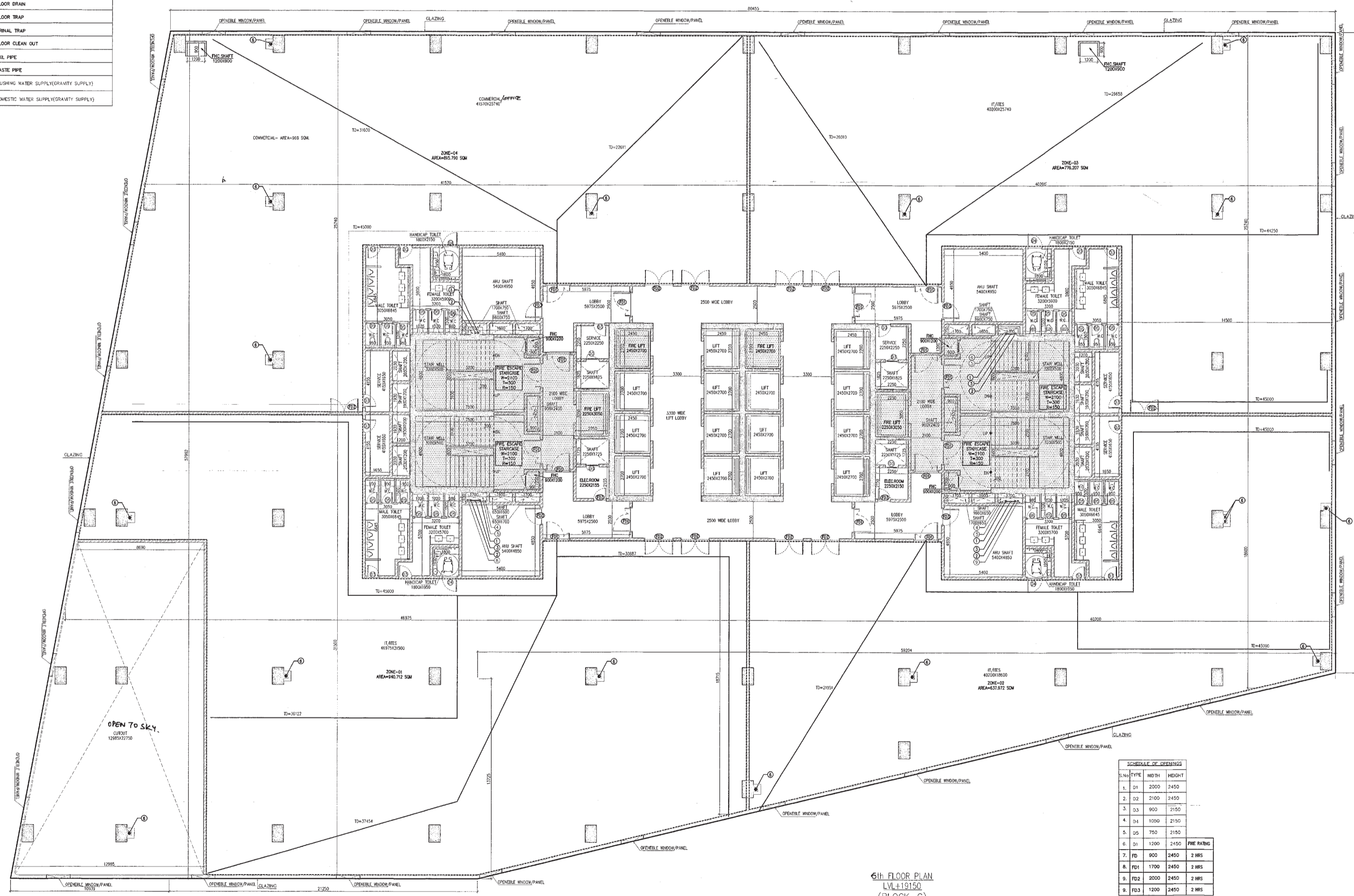

| S.No. | TYPE | WIDTH | HEIGHT | FIRE RATING |
|-------|------|-------|--------|-------------|
| 1. | D1 | 2000 | 2450 | |
| 2. | D2 | 2100 | 2450 | |
| 3. | D3 | 900 | 2150 | |
| 4. | D4 | 1050 | 2150 | |
| 5. | D5 | 750 | 2150 | |
| 6. | D1 | 1200 | 2450 | 2 HRS |
| 7. | D1 | 900 | 2450 | 2 HRS |
| 8. | FD1 | 1700 | 2450 | 2 HRS |
| 9. | FD2 | 2000 | 2450 | 2 HRS |
| 9. | FD3 | 1200 | 2450 | 2 HRS |

5th FLOOR PLAN
 LVL:19150
 (BLOCK-C)

NOTE:-ALL OPENABLE WINDOW / PANEL ARE PROVIDED AT 10M DISTANCE.

Architect
 Hafeez
 Contractor
 29 Bank Street, Bombay 400 022, INDIA

RSMS ARCHITECTS

RSMS ARCHITECTS PVT. LTD.
 69, Nora Niwas, Bhawani Kunj
 (Behind D2), Vasant Kunj,
 New Delhi-110070.
 Tel.: 011-26898616, 26898617
 www.rsms-arch.com

Project:
 PROPOSED BUILDING PLANS OF
 BUILDING - B AND REVISED BUILDING PLANS
 OF BUILDING - C, D, E, & F IN CYBER CITY
 UNDER TRANSIT ORIENTED DEVELOPMENT
 (TOD) POLICY FOR MIX LAND USED
 COLONY (70% IT/ITES + 30% COMMERCIAL)
 MEASURING 108.55922 ACRES IN SECTOR 24,
 25 & 25-A, GURUGRAM MANESAR URBAN
 COMPLEX BEING DEVELOPED BY
 DLF CYBER CITY DEVELOPERS LIM TED

OWNER: DLF Cyber City Developers Ltd.
 10th Floor DLF Gateway Tower,
 DLF Cyber City, Gurugram, Haryana
 Pin: 122002

DRAWING TITLE: -

5th FLOOR PLAN
 BLOCK-C

| REVISION | JOB NO.:- | DRG NO.:- | NOTED:- |
|----------|------------|--------------|---------------|
| | | BC-03 | |
| | SCALE:- | DATE:- | |
| | 1:100 | 01-04-2021 | |
| FILE:- | DEALT BY:- | CHECKED BY:- | APPROVED BY:- |

ARCHITECT'S SEAL & SIGNATURE

OWNER'S SEAL & SIGNATURE