

This is a "PROVISIONAL BUILDING PLAN" approved only for the purpose of inviting objections from the general public.

DRG NO. BE-04

ARCHITECT (R.O.) STP
Mansar Manesar
BPC
Ravi Arora
Mansar Manesar
BPC
Ravi Arora
AD(HO)

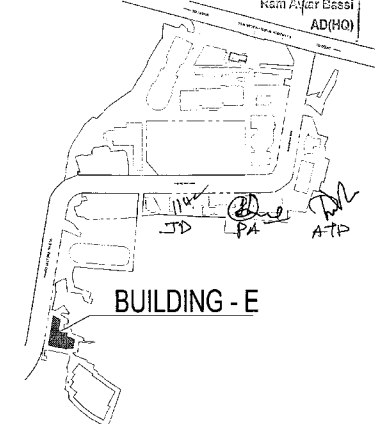

KEY PLAN

DLF49984

Architect
Hafeez
Contractor
27 Bala Street, Borey 40102, 14064709

RISMS
ARCHITECTS

RSMS ARCHITECTS PVT. LTD.
69, Nara Niwas, Bhawani Kunj
(Behind D2), Vasant Kunj,
New Delhi-110070.
Tel.: 011-26898616, 26898617
www.rsms-arch.com

Project:
PROPOSED BUILDING PLANS OF
BUILDING - 3 AND REVISED BUILDING PLANS
OF BUILDING - C, D, E, & F IN CYBER CITY
UNDER TRANSIT ORIENTED DEVELOPMENT
(TOD) POLICY FOR MIX LAND USED
COLONY (70% IT/ITES + 30% COMMERCIAL)
MEASURING 108.55922 ACRES IN SECTOR 24,
25 & 25-A, GURUGRAM MANESAR URBAN
COMPLEX BEING DEVELOPED BY
DLF CYBER CITY DEVELOPERS LIMITED

OWNER: DLF Cyber City Developers Ltd.
10th Floor DLF Gateway Tower,
DLF Cyber City, Gurugram, Haryana
Pin: 122002

DRAWING TITLE: TYPICAL REFUGE (7TH, 11TH, 15TH) FLOOR PLAN BLOCK-E

REVISION: 01
SCALE: 1:100
DATE: 24-04-2021

FILE: DEALT BY: CHECKED BY: APPROVED BY:

ARCHITECT'S SEAL & SIGNATURE: OWNER'S SEAL & SIGNATURE:

REFUGE AREA CALCULATION - 7th, 11th, 15th floor				
GROSS - A				
T1	=	1 X 19.018 X	6.849	= 126.290 SQM
T2	=	0.5 X 18.530 X	4.795	= 44.426 SQM
T3	=	1 X 0.480 X	4.795	= 2.302 SQM
T4	=	1 X 6.340 X	19.600	= 124.284 SQM
			TOTAL	= 297.251 SQM
GROSS - B				
B1	=	1 X 5.400 X	19.600	= 105.840 SQM
B2	=	1 X 19.018 X	6.200	= 117.853 SQM
			TOTAL	= 223.733 SQM
GROSS AREA OF 7TH, 11TH, 15TH FLOOR				= 4559.130 SQM
GROSS AREA OF 8TH, 12TH, 14TH FLOOR				= 5080.238 SQM
TOTAL				= 9639.368 SQM
REFUGE AREA REQUIRED				= (9639.368 X 0.3) + 0.90X (ADDITIONAL SPACE TO ACCOMMODATE WHEEL CHAIR SPACE @ 0.9 SQM PER 200 POPULATION) 4.500
				= 289.181 + 4.500
TOTAL REFUGE AREA PROPOSED				= GROSS-A + GROSS-B = 297.251 + 223.733
REFUGE AREA COUNTED IN FAR				= GROSS-B = 223.733 SQM

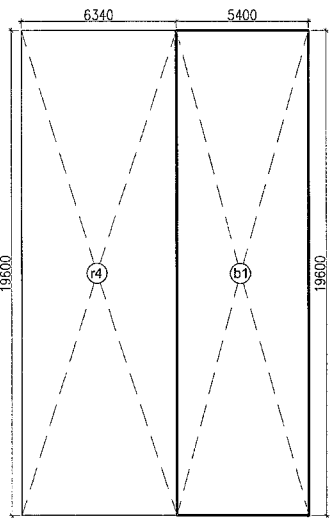

REFUGE AREA CALCULATION (7TH, 11TH, 15TH FLOOR)

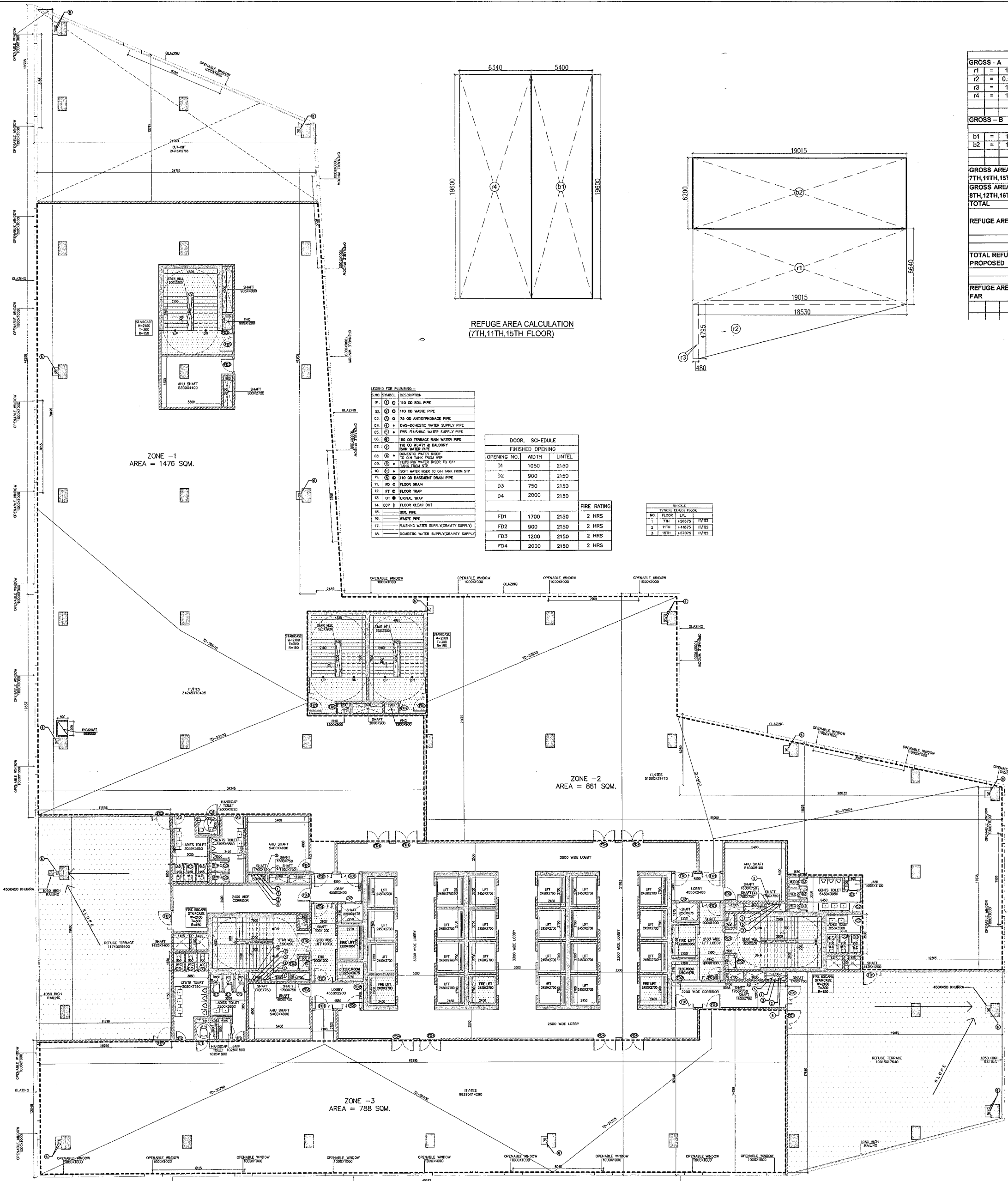
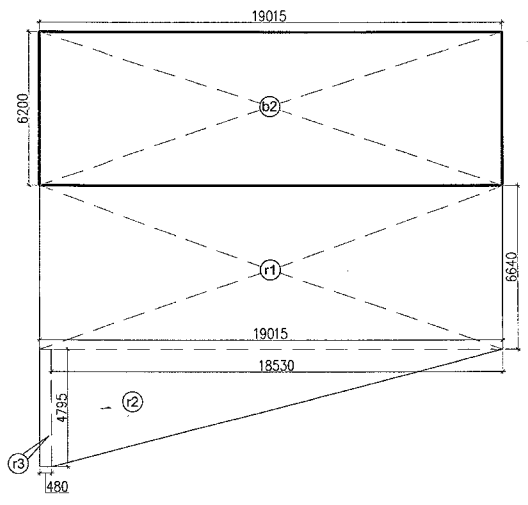

NO.	SYMBOL	DESCRIPTION
01	Ø 150	Ø 150 SOIL PIPE
02	Ø 150	Ø 150 WASTE PIPE
03	Ø 125	Ø 125 AIR EXHAUSTAGE PIPE
04	Ø 125	Ø 125 CONDENSING WATER SUPPLY PIPE
05	Ø 125	Ø 125 FRESH WATER SUPPLY PIPE
06	Ø 125	Ø 125 TRASH & RAIN WATER PIPE
07	Ø 125	Ø 125 WASTE & BALCONY WASTE PIPE
08	Ø 125	Ø 125 WASTE WATER TO W.P.
09	Ø 125	Ø 125 WASTE WATER TO SINK TO SINK
10	Ø 125	Ø 125 WASTE WATER TO SINK TO SINK
11	Ø 125	Ø 125 WASTE WATER TO SINK TO SINK
12	Ø 125	Ø 125 WASTE WATER TO SINK TO SINK
13	Ø 125	Ø 125 WASTE WATER TO SINK TO SINK
14	Ø 125	Ø 125 WASTE WATER TO SINK TO SINK
15	Ø 125	Ø 125 WASTE WATER TO SINK TO SINK
16	Ø 125	Ø 125 WASTE WATER TO SINK TO SINK
17	Ø 125	Ø 125 WASTE WATER TO SINK TO SINK
18	Ø 125	Ø 125 WASTE WATER TO SINK TO SINK
19	Ø 125	Ø 125 WASTE WATER TO SINK TO SINK
20	Ø 125	Ø 125 WASTE WATER TO SINK TO SINK

OPENING NO.	WIDTH	HEIGHT	FIRE RATING
D1	1050	2150	2 HRS
D2	900	2150	2 HRS
D3	750	2150	2 HRS
D4	2000	2150	2 HRS
FD1	1700	2150	2 HRS
FD2	900	2150	2 HRS
FD3	1200	2150	2 HRS
FD4	2000	2150	2 HRS

FLOOR	NO.	WIDTH	HEIGHT	FIRE RATING
7TH	1	1050	2150	2 HRS
11TH	2	900	2150	2 HRS
15TH	3	750	2150	2 HRS

TYPICAL REFUGE FLOOR PLAN 7th, 11th, 15th Floor (BLOCK-E)