

This is a "PROPOSITIONAL BUILDING PLAN" approved only for the purpose of inviting objections from the general public.

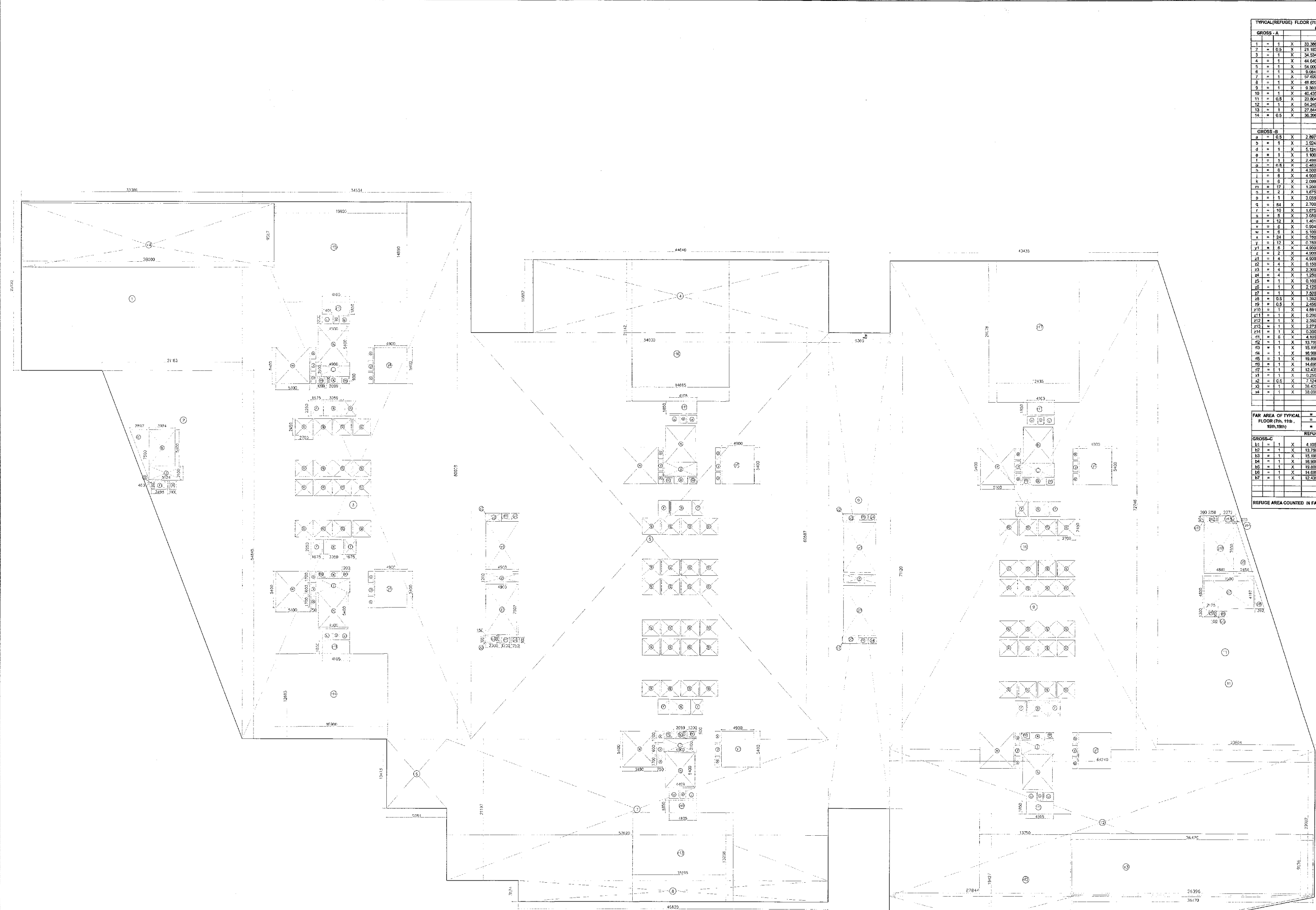

TYPICAL REFUSE FLOOR
(7th, 11th, 15th, 19th) FLOOR
(B.O.C-F)

TYPICAL REFUSE FLOOR (7th, 11th, 15th, 19th) AREA CALCULATION (BLOCK-F)	
GROSS-A	
1 = 1 x 13.36 x 27.42 = 36.55 SQM	
2 = 0.3 x 21.83 x 54.84 = 359.81 SQM	
3 = 1 x 4.34 x 80.84 = 350.84 SQM	
4 = 1 x 44.64 x 10.82 = 482.72 SQM	
5 = 4 x 54.00 x 60.97 = 1321.68 SQM	
6 = 1 x 9.84 x 10.47 = 103.03 SQM	
7 = 1 x 17.68 x 21.97 = 388.23 SQM	
8 = 1 x 48.45 x 3.14 = 152.14 SQM	
9 = 1 x 9.95 x 71.12 = 707.83 SQM	
10 = 1 x 42.45 x 12.74 = 540.45 SQM	
11 = 0.8 x 23.84 x 72.74 = 1385.82 SQM	
12 = 1 x 14.34 x 22.62 = 324.43 SQM	
13 = 1 x 27.84 x 7.18 = 199.97 SQM	
14 = 0.5 x 36.55 x 7.28 = 132.57 SQM	
TOTAL	18978.42 SQM
GROSS-B	
1 = 0.5 x 2.88 x 7.28 = 10.66 SQM	
2 = 1 x 2.54 x 4.50 = 11.43 SQM	
3 = 1 x 5.54 x 2.10 = 11.63 SQM	
4 = 1 x 1.90 x 1.20 = 2.28 SQM	
5 = 1 x 2.48 x 1.20 = 2.98 SQM	
6 = 0.8 x 1.20 x 1.20 = 1.15 SQM	
7 = 1 x 4.00 x 3.40 = 13.60 SQM	
8 = 1 x 4.00 x 2.20 = 8.80 SQM	
9 = 1 x 2.08 x 1.10 = 2.29 SQM	
10 = 1 x 1.50 x 1.20 = 1.80 SQM	
11 = 1 x 1.47 x 2.22 = 3.26 SQM	
12 = 1 x 2.55 x 2.25 = 5.74 SQM	
13 = 1 x 2.70 x 2.48 = 6.70 SQM	
14 = 1 x 1.87 x 2.22 = 4.15 SQM	
15 = 1 x 1.50 x 1.20 = 1.80 SQM	
16 = 1 x 1.50 x 1.20 = 1.80 SQM	
17 = 1 x 1.50 x 1.20 = 1.80 SQM	
18 = 1 x 1.50 x 1.20 = 1.80 SQM	
19 = 1 x 1.50 x 1.20 = 1.80 SQM	
20 = 1 x 1.50 x 1.20 = 1.80 SQM	
21 = 1 x 1.50 x 1.20 = 1.80 SQM	
22 = 1 x 1.50 x 1.20 = 1.80 SQM	
23 = 1 x 1.50 x 1.20 = 1.80 SQM	
24 = 1 x 1.50 x 1.20 = 1.80 SQM	
25 = 1 x 1.50 x 1.20 = 1.80 SQM	
26 = 1 x 1.50 x 1.20 = 1.80 SQM	
27 = 1 x 1.50 x 1.20 = 1.80 SQM	
28 = 1 x 1.50 x 1.20 = 1.80 SQM	
29 = 1 x 1.50 x 1.20 = 1.80 SQM	
30 = 1 x 1.50 x 1.20 = 1.80 SQM	
31 = 1 x 1.50 x 1.20 = 1.80 SQM	
32 = 1 x 1.50 x 1.20 = 1.80 SQM	
33 = 1 x 1.50 x 1.20 = 1.80 SQM	
34 = 1 x 1.50 x 1.20 = 1.80 SQM	
35 = 1 x 1.50 x 1.20 = 1.80 SQM	
36 = 1 x 1.50 x 1.20 = 1.80 SQM	
37 = 1 x 1.50 x 1.20 = 1.80 SQM	
38 = 1 x 1.50 x 1.20 = 1.80 SQM	
39 = 1 x 1.50 x 1.20 = 1.80 SQM	
40 = 1 x 1.50 x 1.20 = 1.80 SQM	
41 = 1 x 1.50 x 1.20 = 1.80 SQM	
42 = 1 x 1.50 x 1.20 = 1.80 SQM	
43 = 1 x 1.50 x 1.20 = 1.80 SQM	
44 = 1 x 1.50 x 1.20 = 1.80 SQM	
45 = 1 x 1.50 x 1.20 = 1.80 SQM	
46 = 1 x 1.50 x 1.20 = 1.80 SQM	
47 = 1 x 1.50 x 1.20 = 1.80 SQM	
48 = 1 x 1.50 x 1.20 = 1.80 SQM	
49 = 1 x 1.50 x 1.20 = 1.80 SQM	
50 = 1 x 1.50 x 1.20 = 1.80 SQM	
51 = 1 x 1.50 x 1.20 = 1.80 SQM	
52 = 1 x 1.50 x 1.20 = 1.80 SQM	
53 = 1 x 1.50 x 1.20 = 1.80 SQM	
54 = 1 x 1.50 x 1.20 = 1.80 SQM	
55 = 1 x 1.50 x 1.20 = 1.80 SQM	
56 = 1 x 1.50 x 1.20 = 1.80 SQM	
57 = 1 x 1.50 x 1.20 = 1.80 SQM	
58 = 1 x 1.50 x 1.20 = 1.80 SQM	
59 = 1 x 1.50 x 1.20 = 1.80 SQM	
60 = 1 x 1.50 x 1.20 = 1.80 SQM	
61 = 1 x 1.50 x 1.20 = 1.80 SQM	
62 = 1 x 1.50 x 1.20 = 1.80 SQM	
63 = 1 x 1.50 x 1.20 = 1.80 SQM	
64 = 1 x 1.50 x 1.20 = 1.80 SQM	
65 = 1 x 1.50 x 1.20 = 1.80 SQM	
66 = 1 x 1.50 x 1.20 = 1.80 SQM	
67 = 1 x 1.50 x 1.20 = 1.80 SQM	
68 = 1 x 1.50 x 1.20 = 1.80 SQM	
69 = 1 x 1.50 x 1.20 = 1.80 SQM	
70 = 1 x 1.50 x 1.20 = 1.80 SQM	
71 = 1 x 1.50 x 1.20 = 1.80 SQM	
72 = 1 x 1.50 x 1.20 = 1.80 SQM	
73 = 1 x 1.50 x 1.20 = 1.80 SQM	
74 = 1 x 1.50 x 1.20 = 1.80 SQM	
75 = 1 x 1.50 x 1.20 = 1.80 SQM	
76 = 1 x 1.50 x 1.20 = 1.80 SQM	
77 = 1 x 1.50 x 1.20 = 1.80 SQM	
78 = 1 x 1.50 x 1.20 = 1.80 SQM	
79 = 1 x 1.50 x 1.20 = 1.80 SQM	
80 = 1 x 1.50 x 1.20 = 1.80 SQM	
81 = 1 x 1.50 x 1.20 = 1.80 SQM	
82 = 1 x 1.50 x 1.20 = 1.80 SQM	
83 = 1 x 1.50 x 1.20 = 1.80 SQM	
84 = 1 x 1.50 x 1.20 = 1.80 SQM	
85 = 1 x 1.50 x 1.20 = 1.80 SQM	
86 = 1 x 1.50 x 1.20 = 1.80 SQM	
87 = 1 x 1.50 x 1.20 = 1.80 SQM	
88 = 1 x 1.50 x 1.20 = 1.80 SQM	
89 = 1 x 1.50 x 1.20 = 1.80 SQM	
90 = 1 x 1.50 x 1.20 = 1.80 SQM	
91 = 1 x 1.50 x 1.20 = 1.80 SQM	
92 = 1 x 1.50 x 1.20 = 1.80 SQM	
93 = 1 x 1.50 x 1.20 = 1.80 SQM	
94 = 1 x 1.50 x 1.20 = 1.80 SQM	
95 = 1 x 1.50 x 1.20 = 1.80 SQM	
96 = 1 x 1.50 x 1.20 = 1.80 SQM	
97 = 1 x 1.50 x 1.20 = 1.80 SQM	
98 = 1 x 1.50 x 1.20 = 1.80 SQM	
99 = 1 x 1.50 x 1.20 = 1.80 SQM	
100 = 1 x 1.50 x 1.20 = 1.80 SQM	
TOTAL	381.873 SQM
FAR AREA OF TYPICAL FLOOR (7th, 11th, 15th, 19th)	GROSS-B
= GROSS-A	= 381.873 SQM
= 18978.42	= 381.873 SQM
NET AREA (7th, 11th, 15th, 19th)	GROSS-C
= 18978.42	= 381.873 SQM
= 18978.42	= 381.873 SQM
REFUSE AREA COUNTED IN FAR	GROSS-C
= GROSS-C	= 381.873 SQM
= 381.873	= 381.873 SQM

DRG NO. BF-11

Architect: Hafeez Contractor
 Member Secretary: BPC
 BPC
 BPC
 DD/MS Member BPC

APD
 PA
 AP

DLF 50019

Architect
 Hafeez
 Contractor

RISMS
 ARCHITECTS

RISMS ARCHITECTS PVT. LTD.
 88, Vardhanna Chowk, New Delhi-110028
 (Delhi-110028)
 Tel: 011-26288678, 26288617
 www.risms-arch.com

PROPOSED BUILDING PLANS OF BUILDING - B AND REVISED BUILDING PLANS OF BUILDING - C, D, E & F IN CYBER CITY UNDER TRANSIT OPERATED DEVELOPMENT (CONDUCTED FOR V.A. AND U.S.D) POLARIS/100% (HLD)/50% (COMMERCIAL) MANSION 108.55322 ACRES IN PLOT NO. 25 & 25-A, KULDEVA VANDERVAHAR COMPLEX BEING DEVELOPED BY M.F. CYBER CITY DEVELOPERS LIMITED

OWNER: M.F. Cyber City Developers
 DLF Cyber City, Gurgaon, Haryana
 122002

AREA CALCULATION OF TYPICAL FLOOR (7th, 11th, 15th, 19th) BLOCK-F

SCALE: 1:200
 DATE: 01.04.2021
 CHECKED BY: [Signature]
 APPROVED BY: [Signature]

ARCHITECT'S SEAL & SIGNATURE
 OWNER'S SEAL & SIGNATURE