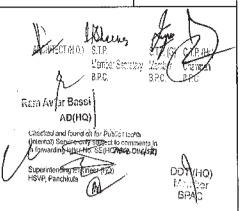

This is a 'PROVISIONAL BUILDING PLAN' approved only for the purpose of inviting objections from the general public

DRG NO. BEST-01

  
 Checked and Found OK by: Public Health  
 (Municipal Corporation) for compliance to  
 the provisions of the Delhi Development Act, 1956  
 and the Delhi Building Rules, 1994  
 Date: 24-04-2021  
 Signature: [Signature]  
 Name: [Name]  
 Designation: [Designation]

PA  
 ATP

TO SECTORS 55 & 56

TO SECTORS

LVL. +241.80  
60M WIDE ROAD

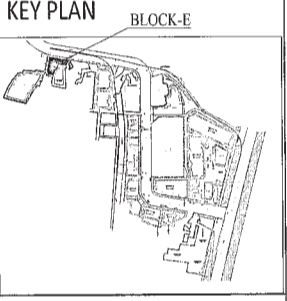
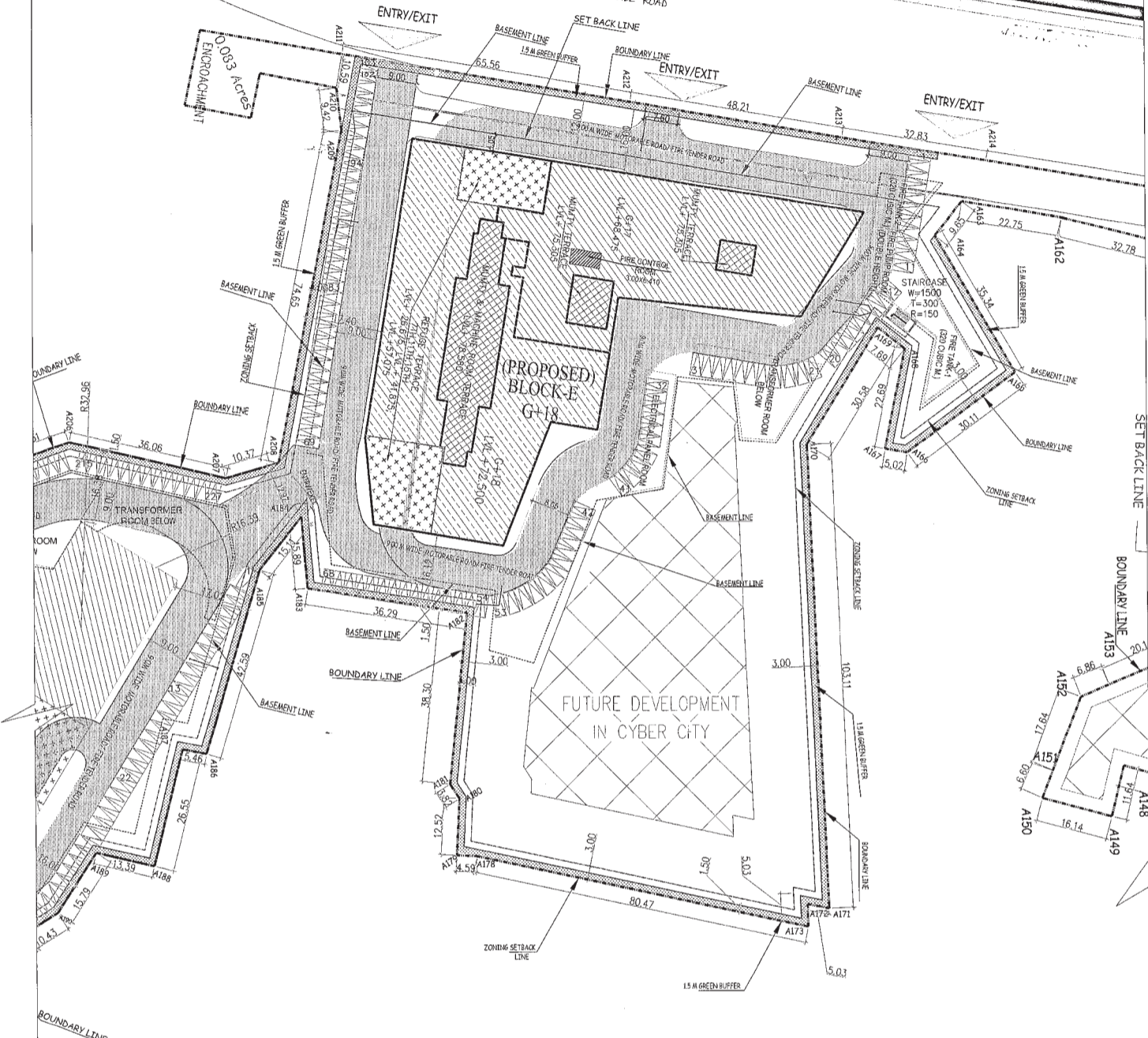

DLF50005

**Architect**  
**Hafeez Contractor**  
 29 Bank Street, Bombay 400 023. Tel: 2661920

**RISIMIS**  
**ARCHITECTS**



RMS ARCHITECTS PVT. LTD.  
 69, Nara Niwas Bhawani Kunj  
 (Behind D2), Vasant Kunj,  
 New Delhi-110070.  
 Tel.: 011-26898616, 26898617  
 www.rsms-arch.com

Project:  
 PROPOSED BUILDING PLANS OF  
 BUILDING - B AND REVISED BUILDING PLANS  
 OF BUILDING - C, D, E, & F IN CYBER CITY  
 UNDER TRANSIT ORIENTED DEVELOPMENT  
 (TOD) POLICY FOR MIX LAND USED COLONY (70%  
 IT/ITES / +30% COMMERCIAL) MEASURING  
 108.55922 ACRES IN SECTOR 24, 25 & 25-A,  
 GURUGRAM MANESAR URBAN COMPLEX BEING  
 DEVELOPED BY  
 DLF CYBER CITY DEVELOPERS LIMITED

OWNER:  
**DLF** DLF Cyber City Developers Ltd.  
 10th Floor DLF Gateway Tower,  
 DLF Cyber City, Gurugram,  
 Haryana Pin: 122002

DRAWING TITLE: -  
 BLOCK-E  
 SITE PLAN

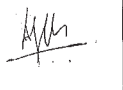
|          |             |               |                |
|----------|-------------|---------------|----------------|
| REVISION | JOB NO. -   | DRG NO. -     | DATE -         |
|          |             | BEST-01       | 24-04-2021     |
| SCALE: - | DATE: -     | DATE: -       | DATE: -        |
| 1:500    | 24-04-2021  |               |                |
| FILE: -  | DEALT BY: - | CHECKED BY: - | APPROVED BY: - |

ARCHITECT'S SEAL & SIGNATURE  
  
 OWNER'S SEAL & SIGNATURE  

| BLOCK        | USAGE      | FLOOR                 | NO OF FLOORS | FAR/FLOOR WISE) | FAR-IT/ COMMERCIAL | NON FAR AREA | GROUND COVERAGE |
|--------------|------------|-----------------------|--------------|-----------------|--------------------|--------------|-----------------|
| BLOCK-E      | COMMERCIAL | GROUND FLOOR          | 1            | 2356.371        | 21739.022          | 2772.079     | 5172.497        |
|              |            | 1st FLOOR             | 1            | 1756.388        |                    |              |                 |
|              |            | 2nd FLOOR             | 1            | 4622.196        |                    |              |                 |
|              |            | 3rd FLOOR             | 1            | 4334.689        |                    |              |                 |
|              |            | 4th FLOOR             | 1            | 4334.689        |                    |              |                 |
|              |            | 5th FLOOR             | 1            | 4334.689        |                    |              |                 |
|              | IT/ITES/   | 6th FLOOR             | 1            | 4334.689        | 53804.197          |              |                 |
|              |            | 7TH REFUGE FLOOR      | 1            | 4052.382        |                    |              |                 |
|              |            | REFUGE TERRACE IN FAR |              |                 |                    |              |                 |
|              |            | 8th FLOOR             | 1            | 4334.689        |                    |              |                 |
|              |            | 9th FLOOR             | 1            | 4334.689        |                    |              |                 |
|              |            | 10th FLOOR            | 1            | 4334.689        |                    |              |                 |
|              |            | 11TH REFUGE FLOOR     | 1            | 4052.382        |                    |              |                 |
|              |            | REFUGE TERRACE IN FAR |              |                 |                    |              |                 |
|              |            | 12th FLOOR            | 1            | 4334.689        |                    |              |                 |
|              |            | 13th FLOOR            | 1            | 4334.689        |                    |              |                 |
|              |            | 14th FLOOR            | 1            | 4334.689        |                    |              |                 |
|              |            | 15TH REFUGE FLOOR     | 1            | 4052.382        |                    |              |                 |
|              |            | REFUGE TERRACE IN FAR |              |                 |                    |              |                 |
|              |            | 16th FLOOR            | 1            | 4334.689        |                    |              |                 |
| 17th FLOOR   | 1          | 4334.689              |              |                 |                    |              |                 |
| 18th FLOOR   | 1          | 2634.850              |              |                 |                    |              |                 |
| BASEMENT     | BASEMENT-1 | 1                     | -            | -               | -                  | -            |                 |
|              | BASEMENT-2 | 1                     | -            | -               | -                  | -            |                 |
|              | BASEMENT-3 | 1                     | -            | -               | -                  | -            |                 |
|              | BASEMENT-4 | 1                     | -            | -               | -                  | -            |                 |
| <b>TOTAL</b> |            |                       |              | 75943.219       | 75943.219          |              |                 |

| FLOOR        | NO OF FLOORS | NET AREA OF BASEMENT | SERVICE AREA | NET PARKING AREA | ECS CAPACITY | TYPE OF ECS  | ECS PROVIDED | ECS PROVIDED | TOTAL ECS |
|--------------|--------------|----------------------|--------------|------------------|--------------|--------------|--------------|--------------|-----------|
|              |              |                      |              |                  |              |              |              |              |           |
| BASEMENT-1   | 1            | 8655.241             | 501.215      | 8354.026         | 261          | DOUBLE STACK | 224.000 X 2  | 448.000      | 1760      |
| BASEMENT-2   | 1            | 9817.998             | 1463.972     | 8354.026         | 261          | DOUBLE STACK | 224.000 X 2  | 448.000      |           |
| BASEMENT-3   | 1            | 8926.903             | 641.154      | 8285.749         | 259          | DOUBLE STACK | 216.000 X 2  | 432.000      |           |
| BASEMENT-4   | 1            | 9817.998             | 1532.249     | 8285.749         | 259          | DOUBLE STACK | 216.000 X 2  | 432.000      |           |
| <b>TOTAL</b> |              |                      |              |                  |              |              |              |              | 102       |

102

1760