

KEY PLAN

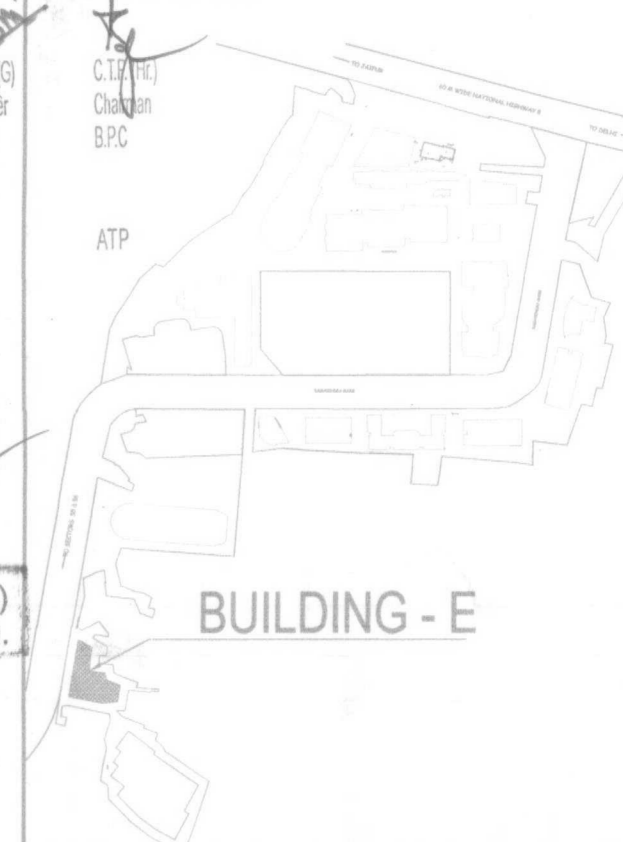

A.D.F.O. (HQ)  
DFS PKL  
Member B.P.C.

(RAM AVTAR BASSI)  
A.D.

BUILDING - E

DLF45432

Architect  
Hafeez  
Contractor

**RISMS**  
ARCHITECTS

RISMS ARCHITECTS PVT. LTD.  
69, Nara Niwas Bhawani Kunj  
(Behind D2), Vasant Kunj,  
New Delhi-110070.  
Tel.: 011-26898616, 26898617  
www.risms-arch.com

Project:  
PROPOSED BUILDING PLAN OF BUILDING - C, BUILDING -D, BUILDING -E AND BUILDING -F IN 94.57485 ACRES DLF CYBER CITY, SECTOR 24, 25 & 25A, GURGAON, HARYANA.

OWNER:  
**DLF** Cyber City Developers Ltd.  
10th Floor DLF Gateway Tower,  
DLF Cyber City, Gurugram, Haryana  
Pin: 122002

DRAWING TITLE:-  
**BUILDING -E**  
AREA CALCULATION OF BASEMENT-01

REVISION	NOB NO.:-	DRG NO. BSE-05	NORTH
	SCALE:- 1:200	DATE:- 16-05-2018	

FILE:- DEALT BY:- CHECKED BY:- APPROVED BY:-

ARCHITECT'S SEAL & SIGNATURE

OWNER'S SEAL & SIGNATURE

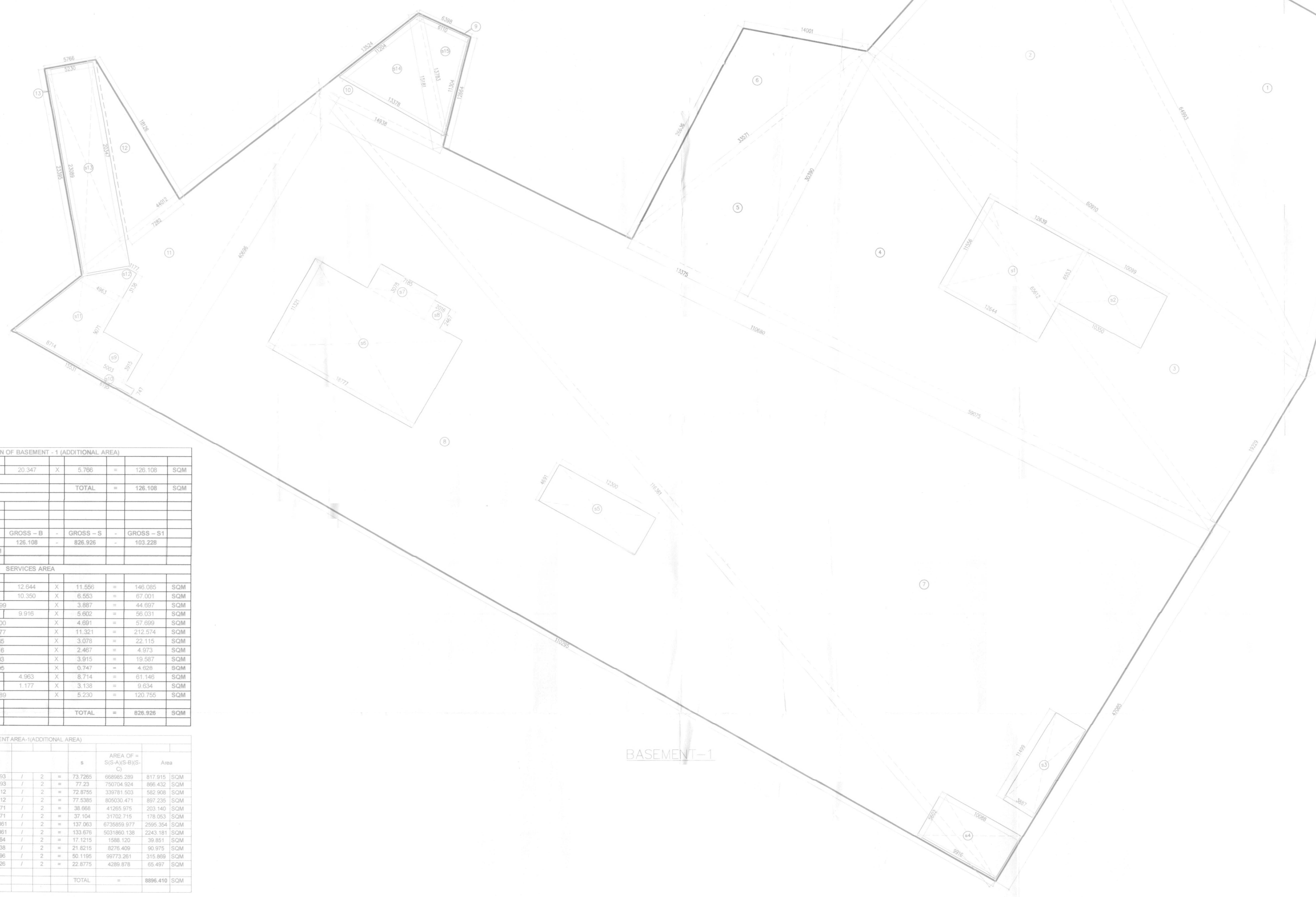

AREA CALCULATION OF BASEMENT - 1 (ADDITIONAL AREA)

GROSS - B								
13	0.5	X	23.395	+	20.347	X	5.786	= 126.108 SQM
								TOTAL = 126.108 SQM

NET AREA OF BASEMENT - 1 (GROSS - 1)

= GROSS - A	+	GROSS - B	-	GROSS - S	-	GROSS - S1
= 8896.410	+	126.108	-	826.926	-	103.228
= 8992.363						SQM

SERVICES AREA

GROSS - S								
s1	0.5	X	12.639	+	12.644	X	11.556	= 146.085 SQM
s2	0.5	X	10.099	+	10.350	X	6.553	= 67.001 SQM
s3	1	X			11.499	X	3.887	= 44.697 SQM
s4	0.5	X	10.088	+	9.916	X	5.602	= 56.031 SQM
s5	1	X			12.300	X	4.691	= 57.699 SQM
s6	1	X			18.777	X	11.321	= 212.574 SQM
s7	1	X			7.185	X	3.078	= 22.115 SQM
s8	1	X			2.016	X	2.467	= 4.973 SQM
s9	1	X			5.003	X	3.915	= 19.567 SQM
s10	1	X			6.195	X	0.747	= 4.628 SQM
s11	0.5	X	9.071	+	4.963	X	8.714	= 61.146 SQM
s12	0.5	X	4.963	+	1.177	X	3.138	= 9.634 SQM
s13	1	X			23.089	X	5.230	= 120.755 SQM
								TOTAL = 826.926 SQM

BASEMENT AREA-1(ADDITIONAL AREA)

NO.	A	B	C	s	AREA OF = S(S-A)(S-B)(S-C)	Area
1	45.359	37.101	64.993	2	73.7285	66865.289
2	28.557	60.910	64.993	2	77.23	750704.924
3	19.229	60.910	65.612	2	72.8755	339781.503
4	59.075	30.390	65.612	2	77.5385	805030.471
5	13.375	30.390	33.571	2	38.668	41255.975
6	14.001	26.636	33.571	2	37.104	31702.719
7	47.085	110.680	116.361	2	137.063	678565.977
8	40.696	110.295	116.361	2	133.676	5031860.138
9	6.398	15.181	12.984	2	17.1215	1588.120
10	13.524	15.181	14.938	2	21.8215	8276.409
11	15.531	44.012	40.695	2	50.1195	99773.281
12	7.282	20.347	18.126	2	22.8775	4289.878
						TOTAL = 8896.410 SQM

GROSS - S1

NO.	A	B	C	s	AREA OF = S(S-A)(S-B)(S-C)	Area
14	11.204	13.378	13.783	2	19.1825	4796.725
15	8.110	13.783	11.304	2	15.5985	1193.956
						TOTAL = 103.228 SQM

BASEMENT-1