

DLF45434

Architect
Hafeez
Contractor



RSMS ARCHITECTS PVT. LTD.
59, Nara Niwas, Bhawani Kunj
(Behind D2), Vasant Kunj,
New Delhi-110070.
Tel: 011-26898616, 26898617
www.rsms-arch.com

Project:
PROPOSED BUILDING PLAN OF BUILDING - C, BUILDING - D, BUILDING - E AND BUILDING - F IN 94.57485 ACRES DLF CYBER CITY, SECTOR 24, 25 & 25A, GURGAON, HARYANA.

OWNER: DLF Cyber City Developers Ltd.
10th Floor DLF Gateway Tower,
DLF Cyber City, Gurugram, Haryana
Pin: 122002

BUILDING - E
AREA CALCULATION OF BASEMENT-03 & 4

REVISION	JOB NO. :- 1-200	DRG NO. :- BSE-07	NORTH -
	SCALE :-	DATE :- 16-05-2018	N
FILE :-	DEALT BY :-	CHECKED BY :-	APPROVED BY :-
ARCHITECT'S SEAL & SIGNATURE:		OWNER'S SEAL & SIGNATURE:	

GROSS - B										BASEMENT AREA-3 (ADDITIONAL AREA)		
NO.	A	B	C	s	AREA OF = S(S-A)(S-B)(S-C)	Area						
1	28.567	+ 45.359	+ 58.679	/ 2	= 86.2975	399135.025	631.771	SQM				
2	58.679	+ 37.101	+ 60.910	/ 2	= 78.345	1107924.203	1052.590	SQM				
3	60.910	+ 66.313	+ 94.255	/ 2	= 110.739	4040941.722	2010.209	SQM				
4	62.819	+ 94.255	+ 33.571	/ 2	= 105.3225	1882139.219	1371.911	SQM				
5	14.001	+ 33.571	+ 26.636	/ 2	= 37.104	31702.715	178.053	SQM				
6	42.882	+ 70.843	+ 82.819	/ 2	= 98.272	2307193.072	1518.945	SQM				
7	23.292	+ 38.003	+ 43.416	/ 2	= 52.3555	195232.003	441.851	SQM				
8	43.126	+ 43.387	+ 45.960	/ 2	= 66.2365	709212.547	842.148	SQM				
9	43.126	+ 29.897	+ 17.125	/ 2	= 45.074	37244.938	192.989	SQM				
10	33.731	+ 29.897	+ 15.181	/ 2	= 39.4045	51487.299	226.908	SQM				
11	6.368	+ 12.664	+ 15.181	/ 2	= 17.1215	1588.120	38.851	SQM				
12	0.566	+ 18.126	+ 18.335	/ 2	= 18.5135	22.963	4.794	SQM				
13	18.335	+ 9.659	+ 23.589	/ 2	= 25.7915	6833.280	82.684	SQM				
15	9.659	+ 1.069	+ 9.590	/ 2	= 10.159	26.272	5.126	SQM				
						TOTAL	=	8999.799	SQM			

GROSS - C										BASEMENT AREA-3 (ADDITIONAL AREA)		
NO.	A	B	C	s	AREA OF = S(S-A)(S-B)(S-C)	Area						
14	=	0.5	X	1.200	+ 0.714	X	0.800	=	0.798	SQM		
16	=	1	X		1.191	X	3.928	=	4.678	SQM		
17	=	1	X		39.776	X	4.879	=	194.057	SQM		
						TOTAL	=	199.511	SQM			

NET AREA OF BASEMENT - 3				
=	GROSS - B	+ GROSS - C	- GROSS - D	- GROSS - E
=	8999.799	+ 199.511	- 612.602	- 106.323
=	8886.485	SQM		

SERVICES AREA										BASEMENT AREA-3 (DEDUCTION AREA)		
NO.	A	B	C	s	AREA OF = S(S-A)(S-B)(S-C)	Area						
s1	11.453	+ 6.110	+ 15.272	/ 2	= 16.4175	962.345	31.022	SQM				
s2	15.272	+ 11.543	+ 13.536	/ 2	= 20.1755	6670.253	75.301	SQM				
						TOTAL	=	106.323	SQM			

SERVICE AREA										BASEMENT AREA-3 (DEDUCTION AREA)		
NO.	A	B	C	s	AREA OF = S(S-A)(S-B)(S-C)	Area						
s3	=	1	X		7.185	X	0.612	=	4.397	SQM		
s4	=	1	X		9.199	X	2.465	=	22.676	SQM		
s5	=	1	X		18.777	X	11.321	=	212.574	SQM		
s6	=	1	X		12.300	X	4.690	=	57.687	SQM		
s7	=	1	X		12.644	X	11.556	=	146.114	SQM		
s8	=	1	X		10.360	X	5.555	=	67.844	SQM		
s9	=	1	X		11.499	X	3.887	=	44.697	SQM		
s10	=	1	X		10.088	X	5.602	=	56.513	SQM		
						TOTAL	=	612.502	SQM			

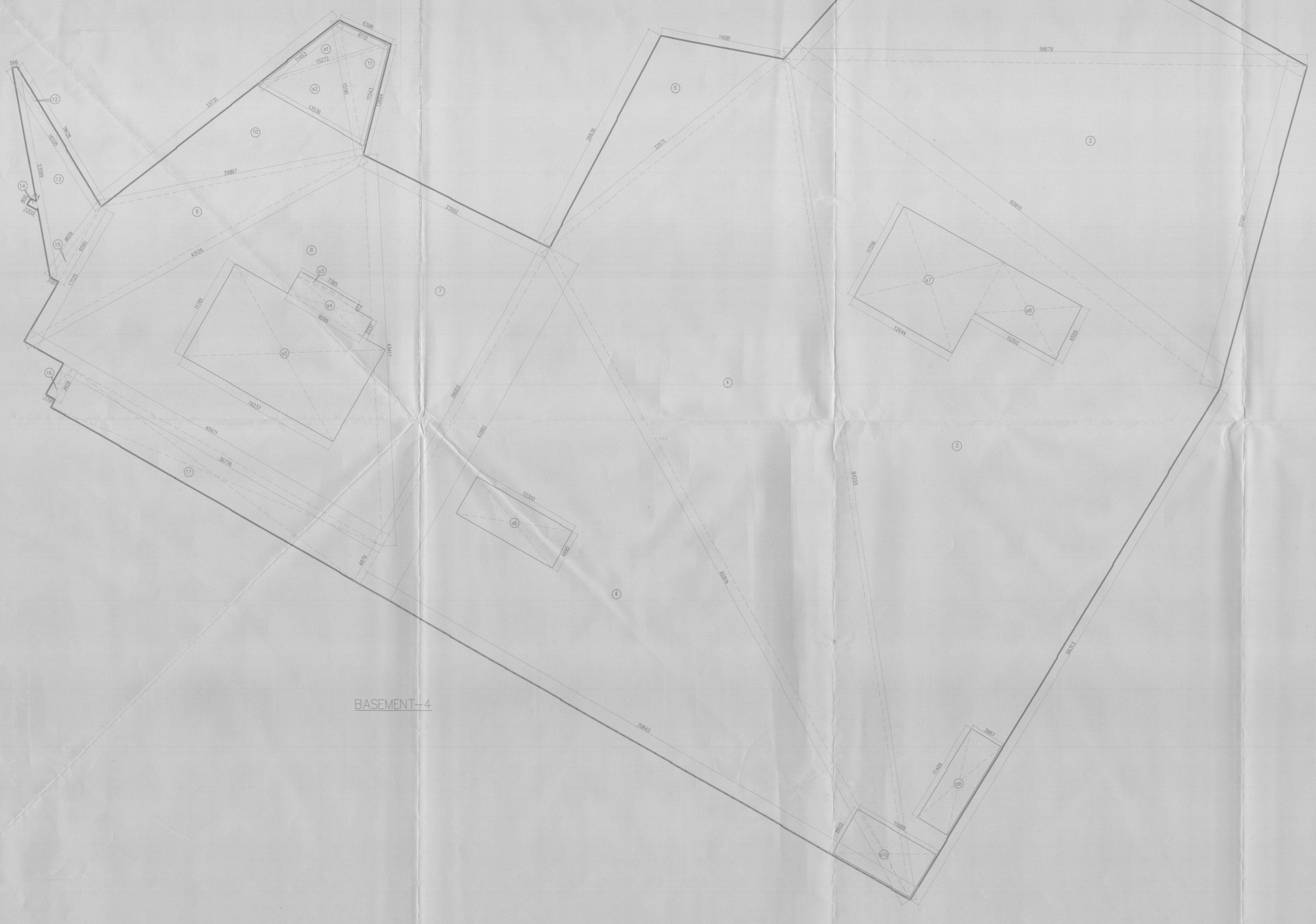

GROSS - B										BASEMENT AREA-3 (ADDITIONAL AREA)		
NO.	A	B	C	s	AREA OF = S(S-A)(S-B)(S-C)	Area						
1	28.567	+ 45.359	+ 58.679	/ 2	= 86.2975	399135.025	631.771	SQM				
2	58.679	+ 37.101	+ 60.910	/ 2	= 78.345	1107924.203	1052.590	SQM				
3	60.910	+ 66.313	+ 94.255	/ 2	= 110.739	4040941.722	2010.209	SQM				
4	62.819	+ 94.255	+ 33.571	/ 2	= 105.3225	1882139.219	1371.911	SQM				
5	14.001	+ 33.571	+ 26.636	/ 2	= 37.104	31702.715	178.053	SQM				
6	42.882	+ 70.843	+ 82.819	/ 2	= 98.272	2307193.072	1518.945	SQM				
7	23.292	+ 38.003	+ 43.416	/ 2	= 52.3555	195232.003	441.851	SQM				
8	43.126	+ 43.387	+ 45.960	/ 2	= 66.2365	709212.547	842.148	SQM				
9	43.126	+ 29.897	+ 17.125	/ 2	= 45.074	37244.938	192.989	SQM				
10	33.731	+ 29.897	+ 15.181	/ 2	= 39.4045	51487.299	226.908	SQM				
11	6.368	+ 12.664	+ 15.181	/ 2	= 17.1215	1588.120	38.851	SQM				
12	0.566	+ 18.126	+ 18.335	/ 2	= 18.5135	22.963	4.794	SQM				
13	18.335	+ 9.659	+ 23.589	/ 2	= 25.7915	6833.280	82.684	SQM				
15	9.659	+ 1.069	+ 9.590	/ 2	= 10.159	26.272	5.126	SQM				
						TOTAL	=	8999.799	SQM			

GROSS - C										BASEMENT AREA-3 (ADDITIONAL AREA)		
NO.	A	B	C	s	AREA OF = S(S-A)(S-B)(S-C)	Area						
14	=	0.5	X	1.200	+ 0.714	X	0.800	=	0.798	SQM		
16	=	1	X		1.191	X	3.928	=	4.678	SQM		
17	=	1	X		39.776	X	4.879	=	194.057	SQM		
						TOTAL	=	199.511	SQM			

NET AREA OF BASEMENT - 3				
=	GROSS - B	+ GROSS - C	- GROSS - D	- GROSS - E
=	8999.799	+ 199.511	- 612.602	- 106.323
=	8886.485	SQM		

SERVICES AREA										BASEMENT AREA-3 (DEDUCTION AREA)		
NO.	A	B	C	s	AREA OF = S(S-A)(S-B)(S-C)	Area						
s1	11.453	+ 6.110	+ 15.272	/ 2	= 16.4175	962.345	31.022	SQM				
s2	15.272	+ 11.543	+ 13.536	/ 2	= 20.1755	6670.253	75.301	SQM				
						TOTAL	=	106.323	SQM			

SERVICE AREA										BASEMENT AREA-3 (DEDUCTION AREA)		
NO.	A	B	C	s	AREA OF = S(S-A)(S-B)(S-C)	Area						
s3	=	1	X		7.185	X	0.612	=	4.397	SQM		
s4	=	1	X		9.199	X	2.465	=	22.676	SQM		
s5	=	1	X		18.777	X	11.321	=	212.574	SQM		
s6	=	1	X		12.300	X	4.690	=	57.687	SQM		
s7	=	1	X		12.644	X	11.556	=	146.114	SQM		
s8	=	1	X		10.360	X	5.555	=	67.844	SQM		
s9	=	1	X		11.499	X	3.887	=	44.697	SQM		
s10	=	1	X		10.088	X	5.602	=	56.513	SQM		
						TOTAL	=	612.502	SQM			