

KEY PLAN

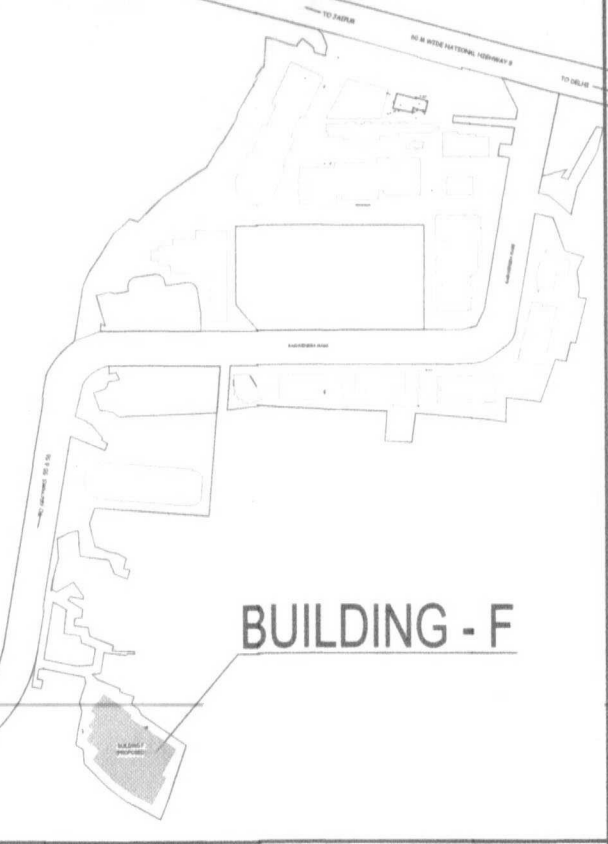

DLF45447

LEGEND FOR PLUMBING-

S.NO.	SYMBOL	DESCRIPTION
01.	①	110 OD SOIL PIPE
02.	②	110 OD WASTE PIPE
03.	③	180 OD WASTE PIPE
04.	④	100 OD WASTE PIPE FOR KITCHEN
05.	⑤	180 OD WASTE PIPE FOR KITCHEN
06.	⑥	75 OD ANTISYPHONAGE PIPE
07.	⑦	COLD WATER SUPPLY PIPE
08.	⑧	FLUSHING WATER SUPPLY PIPE
09.	⑨	160 OD TERRACE RAIN WATER PIPE
10.	⑩	TO O.H. TANK FROM W.P.
11.	⑪	FLUSHING WATER RISER TO O.H. TANK FROM R.I.P.
12.	⑫	110 OD BASEMENT & PODIUM DRAIN PIPE
13.	FD	FLOOR DRAIN
14.	FT	FLOOR TRAP
15.	UT	URINAL TRAP
16.	CDP	FLOOR CLEAN OUT
17.	—	SOIL PIPE
18.	—	WASTE PIPE
19.	—	FLUSHING WATER SUPPLY (GRANITY SUPPLY)
20.	—	DOMESTIC WATER SUPPLY (GRANITY SUPPLY)

DOOR WINDOW SCHEDULE

DOOR	NAME	SIZE	FIRE RATING
D1	3000X2450		
D2	1540X2450		2HR
D3	1000X2450		2HR
D4	1200X2450		2HR

FIRE DOOR SCHEDULE

DOOR	NAME	SIZE	FIRE RATING
FD	2150X2450		2HR
FD1	1540X2450		2HR
FD2	1000X2450		2HR
FD3	1200X2450		2HR



NO. OF CARPARKING = 427 NOS  
BASEMENT-02  
LVL = -200  
(BUILDING - F)

A.D.F.O. (HQ)  
DFS PK.  
Member B.P.C.

Architect (HQ)  
Member Secretary B.P.C.  
Member B.P.C.  
Chairman B.P.C.  
ATP

Checked and found ok for Public Health (Internal) Services on subject to comments in forwarding letter No. SEP/16/174  
Superintending Engineer (H.O.)  
HSVP, Panchkula

(RAM AVTAR BASSI) A.D.

Architect  
Hafeez  
Contractor  
29 Bank Street, Bombay 400 023, Tel: 2661928

**RSMS ARCHITECTS**

RSMS ARCHITECTS PVT. LTD.  
69, Nora Niwas, Bhawani Kunj  
(Behind D2), Vasant Kunj,  
New Delhi-110070.  
Tel.: 011-26898616, 26898617  
www.rsms-arch.com

Project:  
PROPOSED BUILDING PLAN OF BUILDING - C, BUILDING - D, BUILDING - E AND BUILDING - F IN 94.57485 ACRES DLF CYBER CITY, SECTOR 24, 25 & 25A, GURGAON, HARYANA.

OWNER:  
DLF Cyber City Developers Ltd.  
10th Floor DLF Gateway Tower,  
DLF Cyber City, Gurugram,  
Haryana Pin: 122002

DRAWING TITLE:-  
**BUILDING - F  
BASEMENT-02  
FLOOR PLAN**

REVISION	JOB NO. :-	DRG NO. :-	NORTH :-
		BSF-02	N
	SCALE:-	DATE:-	
	1:300	16-05-2018	
FILE:-	DEALT BY:-	CHECKED BY:-	APPROVED BY:-

ARCHITECT'S SEAL & SIGNATURE  
OWNER'S SEAL & SIGNATURE

