

KEY PLAN

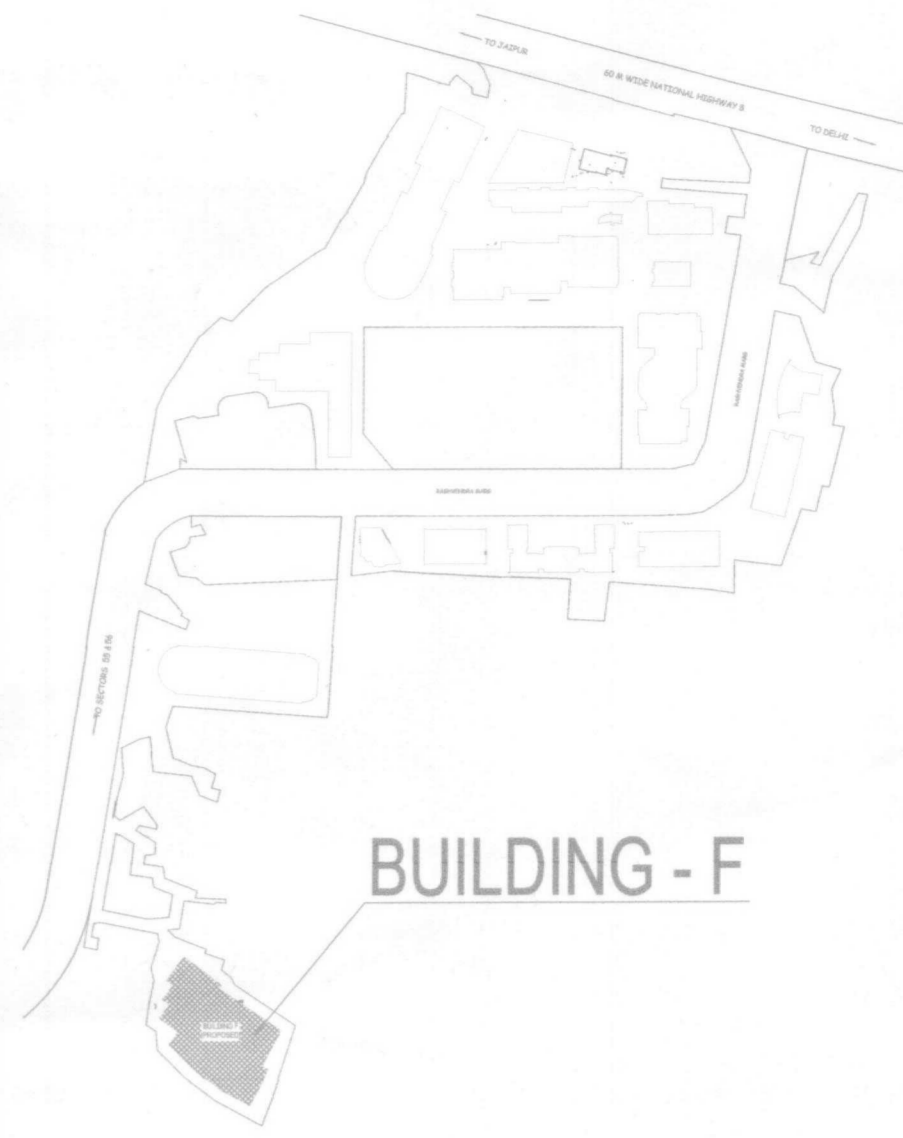

BASEMENT-02 (BLOCK-F)

BASEMENT AREA									
NO	A	B	C	s	AREA OF = S(S-A)S-B(S-C)	Area			
1	48.98	+ 49.910	+ 5.695	/ 2	= 52.2925	19230.511	138.674	SQM	
2	49.910	+ 58.615	+ 40.895	/ 2	= 74.71	1008385.247	1004.189	SQM	
3	58.615	+ 60.945	+ 18.210	/ 2	= 67.885	225880.238	475.058	SQM	
4	60.945	+ 80.455	+ 26.300	/ 2	= 83.85	375248.072	612.575	SQM	
5	80.455	+ 74.535	+ 11.675	/ 2	= 83.333	151164.799	389.799	SQM	
6	74.535	+ 88.260	+ 18.640	/ 2	= 90.7175	260033.877	509.935	SQM	
7	88.260	+ 99.545	+ 30.855	/ 2	= 109.33	1768870.496	1329.989	SQM	
8	99.545	+ 112.940	+ 25.215	/ 2	= 118.85	1269681.196	1126.801	SQM	
9	112.940	+ 113.045	+ 10.655	/ 2	= 118.32	361524.260	601.269	SQM	
10	113.045	+ 105.910	+ 14.195	/ 2	= 116.575	449320.377	670.314	SQM	
11	105.910	+ 167.415	+ 91.710	/ 2	= 182.5175	19176485.347	4378.982	SQM	
12	167.415	+ 167.670	+ 25.440	/ 2	= 180.263	4515127.844	2124.883	SQM	
13	167.670	+ 142.500	+ 55.720	/ 2	= 182.945	14379343.639	3792.011	SQM	
14	142.500	+ 130.670	+ 40.245	/ 2	= 156.7075	6751384.439	2598.343	SQM	
15	130.670	+ 65.750	+ 90.405	/ 2	= 143.4125	7622987.453	2742.806	SQM	
16	65.750	+ 54.755	+ 13.495	/ 2	= 67	54870.381	234.244	SQM	
17	54.755	+ 46.365	+ 35.415	/ 2	= 68.2675	663761.134	814.715	SQM	
TOTAL						=	23543.588	SQM	

SERVICES AREA									
NO	A	B	C	s	AREA OF = S(S-A)S-B(S-C)	Area			
S20	10.385	+ 8.665	+ 6.545	/ 2	= 12.7875	797.202	28.235	SQM	
S21	11.085	+ 9.165	+ 11.655	/ 2	= 15.9525	2254.960	47.582	SQM	
S22	11.655	+ 8.665	+ 11.675	/ 2	= 15.9975	2201.806	46.923	SQM	
S23	10.385	+ 27.700	+ 18.785	/ 2	= 28.425	3587.842	59.899	SQM	
S24	27.700	+ 35.285	+ 9.060	/ 2	= 36.0225	5961.422	77.210	SQM	
S25	3.900	+ 13.875	+ 14.410	/ 2	= 16.0925	732.040	27.056	SQM	
S26	12.790	+ 14.410	+ 4.005	/ 2	= 15.6025	606.889	24.635	SQM	
S27	4.745	+ 4.160	+ 2.280	/ 2	= 5.5925	22.490	4.742	SQM	
S28	21.780	+ 4.745	+ 17.275	/ 2	= 21.9	208.510	14.440	SQM	
S29	5.790	+ 17.275	+ 17.425	/ 2	= 20.245	2450.989	49.507	SQM	
S30	17.425	+ 40.485	+ 35.980	/ 2	= 46.945	98162.780	313.309	SQM	
S31	35.980	+ 36.875	+ 4.160	/ 2	= 38.5075	5457.388	73.874	SQM	
S32	36.875	+ 44.155	+ 13.140	/ 2	= 47.085	47813.634	218.663	SQM	
S33	13.920	+ 38.000	+ 39.110	/ 2	= 45.515	69218.315	263.094	SQM	
S34	17.290	+ 39.110	+ 32.780	/ 2	= 44.59	78782.648	280.682	SQM	
S35	21.190	+ 32.780	+ 35.065	/ 2	= 44.5175	115218.245	339.438	SQM	
S36	17.430	+ 21.190	+ 8.690	/ 2	= 23.61	5300.057	72.801	SQM	
S37	13.955	+ 17.430	+ 25.840	/ 2	= 28.4175	11953.167	109.331	SQM	
S38	6.850	+ 23.940	+ 23.425	/ 2	= 30.5575	7287.936	85.369	SQM	
S39	14.280	+ 28.425	+ 31.495	/ 2	= 37.09	41051.724	202.612	SQM	
S40	16.285	+ 42.590	+ 31.495	/ 2	= 45.175	46184.144	214.905	SQM	
S41	6.515	+ 13.245	+ 16.265	/ 2	= 18.0125	1725.382	41.538	SQM	
TOTAL						=	2595.857	SQM	

AREA CALCULATION OF BASEMENT - 02										
SERVICES AREA OF BASEMENT - 02										
GROSS - B	0.5	X	3.735	+	10.745	X	4.065	=	29.431	SQM
S2	0.5	X	7.170	+	10.745	X	10.745	=	38.521	SQM
S3	0.5	X	7.050	+	10.830	X	10.830	=	38.176	SQM
S4	1	X	3.785	+	8.960	X	8.960	=	33.914	SQM
S5	1	X	8.670	+	6.550	X	6.550	=	56.789	SQM
S6	1	X	14.450	+	11.815	X	11.815	=	170.727	SQM
S8	1	X	2.620	+	7.130	X	7.130	=	18.681	SQM
S9	1	X	3.270	+	6.650	X	6.650	=	21.746	SQM
S10	1	X	6.700	+	6.455	X	6.455	=	43.249	SQM
S11	0.5	X	6.420	+	5.750	X	5.750	=	18.458	SQM
S12	0.5	X	5.740	+	6.375	X	6.375	=	18.296	SQM
S13	1	X	5.000	+	2.550	X	2.550	=	12.750	SQM
S14	0.5	X	5.760	+	5.155	X	5.155	=	14.846	SQM
S15	0.5	X	5.850	+	5.100	X	5.100	=	14.918	SQM
S15a	0.5	X	2.850	+	2.250	X	2.250	=	3.206	SQM
S16	0.5	X	2.300	+	2.810	X	2.810	=	3.232	SQM
S17	0.5	X	13.265	+	13.600	X	15.275	=	205.181	SQM
S18	0.5	X	10.045	+	25.075	X	25.075	=	125.939	SQM
S19	0.5	X	5.310	+	7.470	X	7.470	=	19.833	SQM
S42	0.5	X	2.530	+	2.585	X	0.200	=	0.512	SQM
TOTAL						=	887.890	SQM		
NET AREA OF BASEMENT - 02 (GROSS - 1)										
= GROSS - A						=	23543.588	SQM		
= GROSS - B						=	887.890	SQM		
= GROSS - C						=	2595.857	SQM		
= GROSS - D						=	67.212	SQM		
NET AREA FOR PARKING OF BASEMENT - 02						=	23543.588	SQM		
= GROSS - 1						=	23543.588	SQM		
= GROSS - 2						=	20127.063	SQM		
NO OF CAR ACHIEVABLE						=	20127.063	/	32	
OR SAY						=	628.970	CARS		

BASEMENT - 02 - DEDUCTIOAL AREA									
ARC AREA	GROSS - D								
D1	3.14	X	11.500	X	11.500	X	97.49	/	360
D2	3.14	X	11.495	X	11.495	X	72.31	/	360
TOTAL						=	67.212	SQM	

A.D.F.O. (HQ) DFS PKL Member B.P.C.
 (RAM AVTAR BASSI) A.D.

DLF45451

Architect Hafeez Contractor
 29, Nara Street, Bombay 400 023, Tel: 26549328

RISMS ARCHITECTS

RISMS ARCHITECTS PVT. LTD.
 69, Nara Niwas Bhawani Kunj (Behind D2), Vasant Kunj, New Delhi - 110070.
 Tel.: 011-26898616, 26898617
 www.risms-arch.com

Project: PROPOSED BUILDING PLAN OF BUILDING - C, BUILDING - D, BUILDING - E AND BUILDING - F IN 94.57485 ACRES DLF CYBER CITY, SECTOR 24, 25 & 25A, GURGAON, HARYANA.
 OWNER: DLF Cyber City Developers Ltd.
 10th Floor DLF Gateway Tower, DLF Cyber City, Gurugram, Haryana Pin: 122002

DRAWING TITLE: - BUILDING-F BASEMENT-02 AREA CALCULATION
 REVISION JOB NO. - DRG NO. BSF-06 NORTH - N
 SCALE: - 1:300 DATE: - 16-05-2018
 FILE: - DEALT BY: - CHECKED BY: - APPROVED BY: -
 ARCHITECT'S SEAL & SIGNATURE OWNER'S SEAL & SIGNATURE