

DLF45465

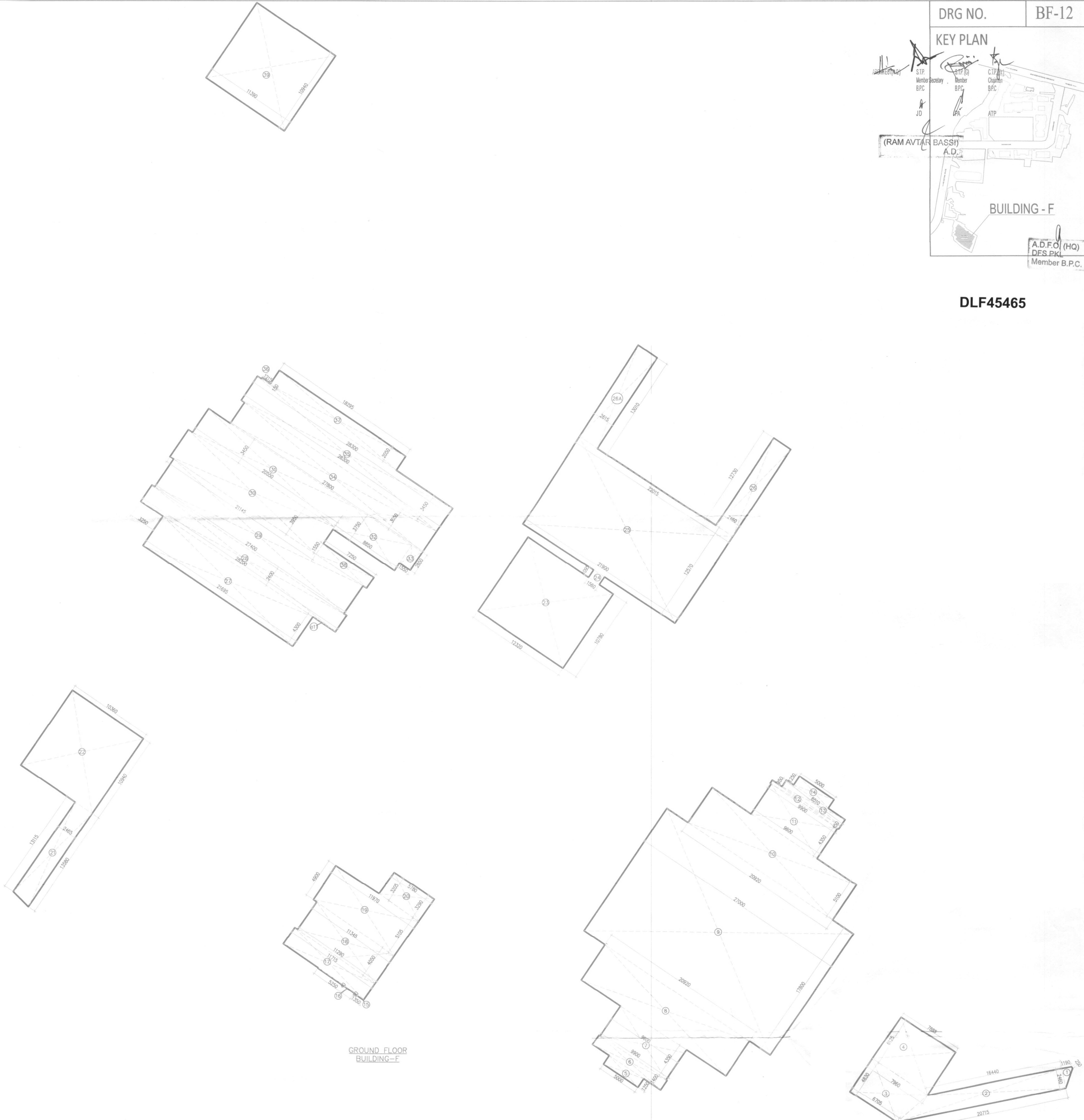

GROUND FLOOR BUILDING-F

AREA CALCULATION OF GROUND FLOOR (BUILDING - F)									
GROSS - A									
1	0.5	X	0.250	+	2.460	X	1.190	=	1.612
2	0.5	X	16.440	+	20.715	X	2.460	=	45.701
3	0.5	X	6.705	+	7.960	X	4.830	=	35.416
4	0.5	X	7.960	+	7.885	X	6.125	=	48.525
5	1	X	5.000	X	1.250	=	6.250		
6	1	X	9.900	X	1.400	=	13.860		
7	1	X	9.600	X	4.350	=	41.760		
8	1	X	20.920	X	5.100	=	106.692		
9	1	X	27.000	X	17.800	=	480.600		
10	1	X	20.920	X	5.100	=	106.692		
11	1	X	9.600	X	4.350	=	41.760		
12	1	X	9.900	X	0.450	=	4.455		
13	1	X	8.510	X	0.950	=	8.085		
14	1	X	5.000	X	1.250	=	6.250		
15	1	X	1.350	X	0.090	=	0.122		
16	1	X	5.250	X	0.040	=	0.210		
17	1	X	11.715	X	2.400	=	28.116		
18	0.5	X	11.290	+	11.345	X	4.050	=	45.836
19	0.5	X	4.900	+	5.105	X	11.970	=	59.880
20	0.5	X	3.205	+	3.290	X	5.780	=	18.771
21	0.5	X	13.115	+	13.580	X	2.465	=	32.902
22	1	X	10.360	X	10.940	=	113.338		
23	1	X	12.320	X	10.780	=	132.810		
24	1	X	1.560	X	1.095	=	1.708		
25	0.5	X	21.900	+	22.015	X	12.570	=	276.006
26	1	X	2.460	X	12.530	=	30.824		
26A	1	X	2.615	X	13.010	=	34.021		
27	1	X	21.695	X	4.300	=	93.288		
28	1	X	28.200	X	2.400	=	67.680		
29	1	X	27.400	X	4.050	=	110.970		
30	1	X	21.145	X	3.950	=	83.523		
31	1	X	20.550	X	3.450	=	70.898		
32	1	X	8.850	X	3.750	=	33.188		
33	1	X	1.550	X	2.650	=	4.108		
34	1	X	27.800	X	3.050	=	84.790		
35	1	X	28.300	X	3.450	=	97.635		
36	1	X	1.215	X	0.150	=	0.182		
37	1	X	18.295	X	2.050	=	37.505		
38	1	X	7.250	X	1.550	=	11.238		
39	1	X	11.390	X	10.940	=	124.607		
TOTAL									2541.810
TOTAL FAR AREA OF GROUND FLOOR = GROSS - A									
									2541.810
									SQM

Architect
Hafeez
Contractor

RSMS
ARCHITECTS

RSMS ARCHITECTS PVT. LTD.
69, Nora Niwas Bhowani Kunj
(Behind D2), Vasant Kunj,
New Delhi-110070.
Tel.: 011-26898616, 26898617
www.rsms-arch.com

Project:
PROPOSED BUILDING PLAN OF BUILDING - C, BUILDING - D, BUILDING - E AND BUILDING - F IN 94.57485 ACRES DLF CYBER CITY, SECTOR 24, 25 & 25A, GURGAON, HARYANA.

OWNER: DLF Cyber City Developers Ltd.
10th Floor DLF Gateway Tower,
DLF Cyber City, Gurugram,
Haryana Pin: 122002

DRAWING TITLE:-
BUILDING-F
AREA CALCULATION OF GROUND FLOOR

REVISION	JOB NO.:-	DRG NO.	NORTH:-
		BF-12	N
	SCALE:-	DATE:-	
	1:200	16-05-2018	

FILE:- DEALT BY:- CHECKED BY:- APPROVED BY:-

ARCHITECT'S SEAL & SIGNATURE
OWNER'S SEAL & SIGNATURE

