

KEY PLAN

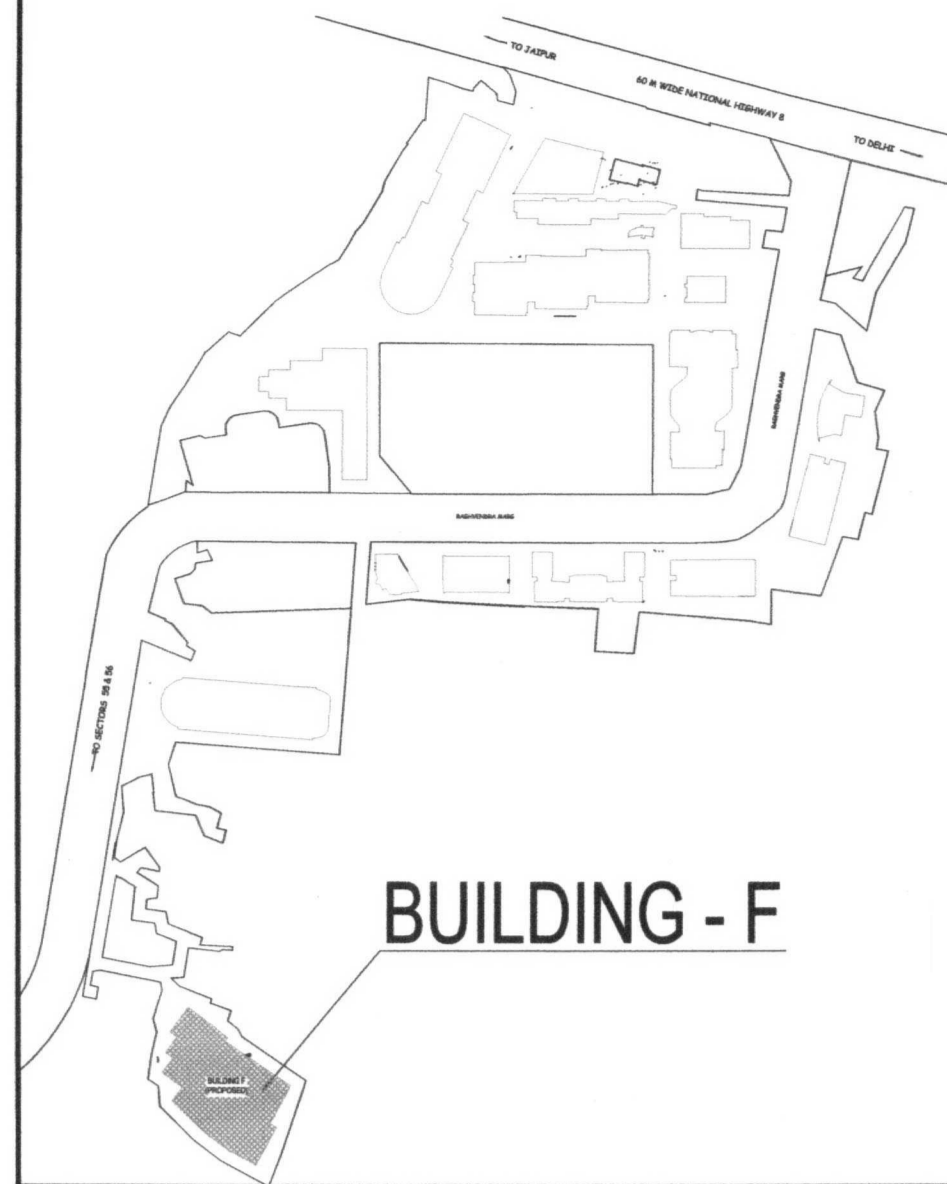

BUILDING - F

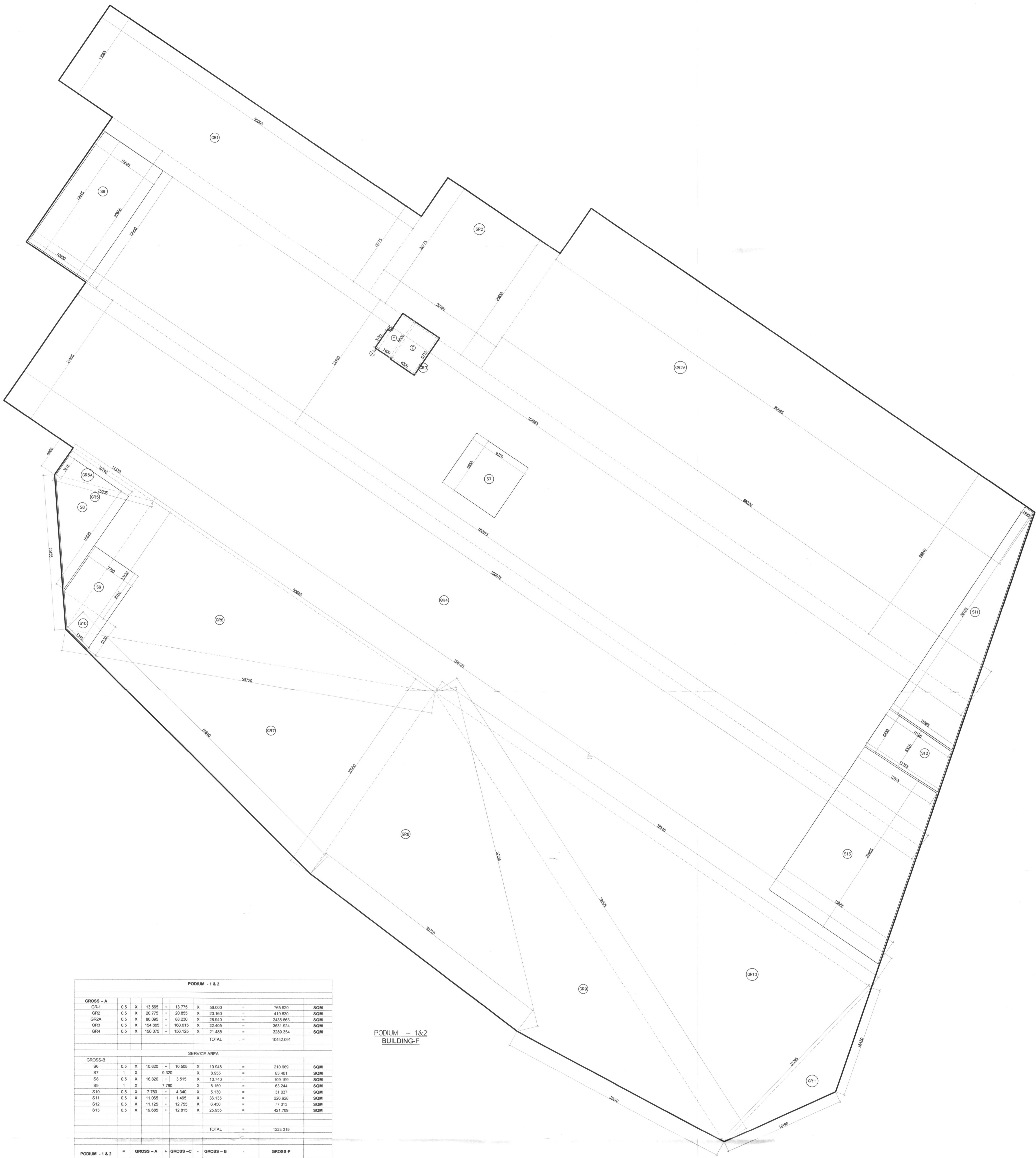

PODIUM - 1 & 2										
GROSS - A										
GR1	0.5	X	13.965	+	13.775	X	56.000	=	785.620	SQM
GR2	0.5	X	20.775	+	22.855	X	25.150	=	419.630	SQM
GR2A	0.5	X	80.595	+	88.230	X	28.940	=	2435.663	SQM
GR3	0.5	X	154.665	+	160.615	X	22.405	=	3531.654	SQM
GR4	0.5	X	150.075	+	156.125	X	21.485	=	3289.354	SQM
TOTAL									10442.091	SQM
SERVICE AREA										
GROSS - B										
S6	0.5	X	10.620	+	10.505	X	19.945	=	210.869	SQM
S7	1.1	X	8.320	+	8.555	X	8.955	=	83.461	SQM
S8	0.5	X	16.820	+	3.515	X	10.740	=	109.199	SQM
S9	1.1	X	7.760	+	7.760	X	8.150	=	63.344	SQM
S10	0.5	X	7.760	+	4.340	X	5.130	=	31.037	SQM
S11	0.5	X	11.955	+	1.495	X	36.135	=	226.928	SQM
S12	0.5	X	11.025	+	12.295	X	6.400	=	77.013	SQM
S13	0.5	X	18.885	+	12.815	X	25.955	=	421.769	SQM
TOTAL									1223.319	SQM
PODIUM - 1 & 2										
= GROSS - A + GROSS - C - GROSS - B									GROSS - P	
= 10442.091 + 4284.013 - 1223.319									45.660	SQM
									13457.125	SQM

PODIUM - 1&2 BUILDING-F

PODIUM AREA										
NO.	A	B	C	s	AREA OF = (S(A)X(B) (S-C)	Area				
GR5	15.205	+	23.155	+	23.120	/ 2 =	30.74	27691.055	166.136	SQM
GR5A	15.205	+	4.960	+	14.370	/ 2 =	17.2675	1270.038	35.638	SQM
GR6	23.120	+	50.665	+	55.720	/ 2 =	64.7875	343438.081	598.034	SQM
GR7	51.640	+	65.720	+	32.950	/ 2 =	70.155	597590.315	835.219	SQM
GR8	38.720	+	32.950	+	52.215	/ 2 =	61.9425	405680.942	636.931	SQM
GR9	52.215	+	79.895	+	35.010	/ 2 =	83.56	466047.217	682.677	SQM
GR10	79.895	+	78.545	+	31.795	/ 2 =	95.1175	1519471.250	1232.988	SQM
GR11	31.795	+	18.190	+	18.430	/ 2 =	33.2075	11618.151	108.711	SQM
TOTAL									4284.013	SQM

TOILET AREA							
X	=	3.150	X	0.5	=	1.575	SQM
Y	=	6.6	X	2.400	=	15.84	SQM
Z	=	6.735	X	4.2	=	28.245	SQM
TOTAL GROSS-P					=	45.66	SQM
NON FAR AREA OF PODIUM					=	GROSS-A - GROSS-P	
					=	10442.091 - 45.660	
					=	10396.431	SQM

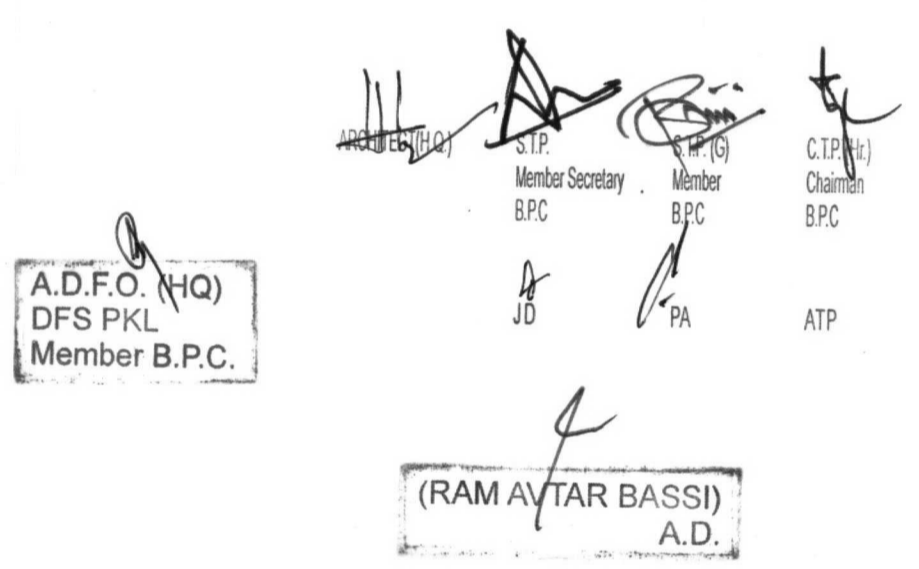

DLF45466

Architect
Hafeez Contractor

29 Bunk Street, Bombay 400 023, Tel:261929

RSMIS ARCHITECTS

RSMIS ARCHITECTS PVT. LTD.
69, Nora Niwas, Bhawani Kunj
(Behind D2), Vasant Kunj,
New Delhi-110070.
Tel.: 011-26898616, 26898617
www.rsmis-arch.com

Project:
PROPOSED BUILDING PLAN OF BUILDING - C, BUILDING -D, BUILDING -E AND BUILDING -F IN 94.57485 ACRES DLF CYBER CITY, SECTOR 24, 25 & 25A, GURGAON, HARYANA.

OWNER: DLF Cyber City Developers Ltd.
10th Floor DLF Gateway Tower,
DLF Cyber City, Gurugram, Haryana
Pin: 122002

DRAWING TITLE: - BUILDING-F
AREA CALCULATION OF PODIUM-01,02

REVISION	JOB NO. -	DRG NO. -	NORTH -
		BF-13	N
	SCALE: -	DATE: -	
	1:200	16-05-2018	
FILE: -	DEALT BY: -	CHECKED BY: -	APPROVED BY: -
ARCHITECT'S SEAL & SIGNATURE	OWNER'S SEAL & SIGNATURE		

