

KEY PLAN

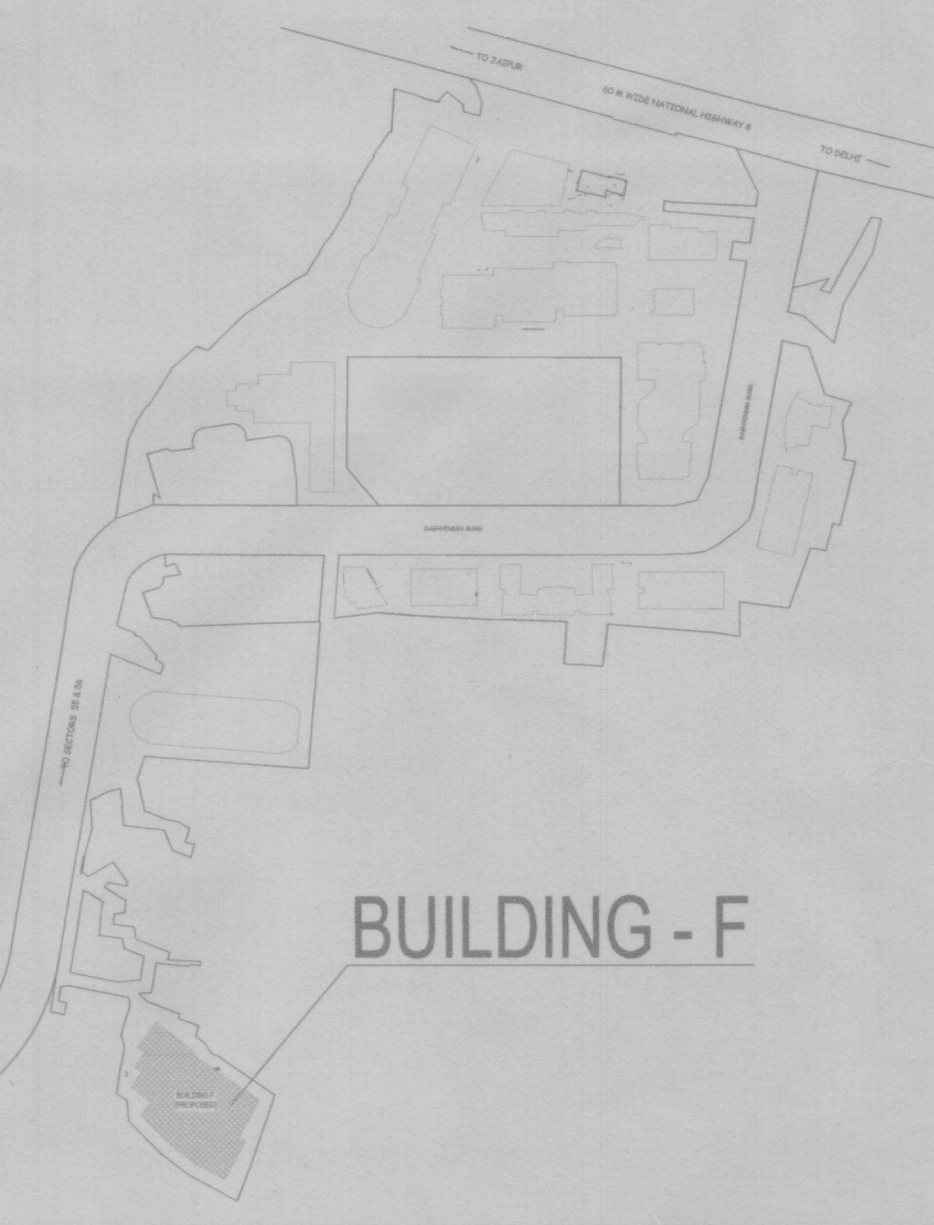

BUILDING - F



A.D.P.C. (HO)
DPS P&L
Member B.P.C.

(RAM AVTAR BASSI)
A.D.

DLF45470

Architect
Hafeez
Contractor

RISIMS
ARCHITECTS

RSMS ARCHITECTS PVT. LTD.
69, Nora Niwas, Bhawani Kunj
(Behind D2), Vasant Kunj,
New Delhi-110070.
Tel: 011-26898616, 26898617
www.rsms-arch.com

Project:
PROPOSED BUILDING PLAN OF BUILDING - C, BUILDING - D, BUILDING - E AND BUILDING - F IN 94.57485 ACRES DLF CYBER CITY, SECTOR 24, 25 & 25A, GURGAON, HARYANA.

OWNER: DLF Cyber City Developers Ltd.
10th Floor, DLF Gateway Tower,
DLF Cyber City, Gurugram, Haryana
Pin: 122002

DRAWING TITLE: BUILDING-F
AREA CALCULATION OF
7th to 9th, 11th to 13th, 15 & 16th
FLOOR

REVISION	JOB NO. -	DRG NO. -	NORTH -
		BF-14(c)	N
	SCALE -	DATE -	
	1:200	16-05-2018	

FILE -	DEALT BY -	CHECKED BY -	APPROVED BY -

ARCHITECT'S SEAL & SIGNATURE

OWNER'S SEAL & SIGNATURE

NO	A	B	C	D	E	AREA OF + (S.C.)	Area
1	37.00	37.00	36.44	2	42.6675	1562.250	1562.25 SQM
2	38.44	37.00	38.00	2	57.0075	4275.562	4275.56 SQM
3	38.00	37.00	36.44	2	42.6675	1562.250	1562.25 SQM
4	38.44	37.00	38.00	2	57.0075	4275.562	4275.56 SQM
5	38.44	37.00	38.00	2	57.0075	4275.562	4275.56 SQM
6	38.44	37.00	38.00	2	57.0075	4275.562	4275.56 SQM
7	38.44	37.00	38.00	2	57.0075	4275.562	4275.56 SQM
8	38.44	37.00	38.00	2	57.0075	4275.562	4275.56 SQM
9	38.44	37.00	38.00	2	57.0075	4275.562	4275.56 SQM
10	38.44	37.00	38.00	2	57.0075	4275.562	4275.56 SQM
11	38.44	37.00	38.00	2	57.0075	4275.562	4275.56 SQM
12	38.44	37.00	38.00	2	57.0075	4275.562	4275.56 SQM
13	38.44	37.00	38.00	2	57.0075	4275.562	4275.56 SQM
14	38.44	37.00	38.00	2	57.0075	4275.562	4275.56 SQM
15	38.44	37.00	38.00	2	57.0075	4275.562	4275.56 SQM
16	38.44	37.00	38.00	2	57.0075	4275.562	4275.56 SQM
17	38.44	37.00	38.00	2	57.0075	4275.562	4275.56 SQM
18	38.44	37.00	38.00	2	57.0075	4275.562	4275.56 SQM
19	38.44	37.00	38.00	2	57.0075	4275.562	4275.56 SQM
20	38.44	37.00	38.00	2	57.0075	4275.562	4275.56 SQM
21	38.44	37.00	38.00	2	57.0075	4275.562	4275.56 SQM
22	38.44	37.00	38.00	2	57.0075	4275.562	4275.56 SQM
23	38.44	37.00	38.00	2	57.0075	4275.562	4275.56 SQM
24	38.44	37.00	38.00	2	57.0075	4275.562	4275.56 SQM
25	38.44	37.00	38.00	2	57.0075	4275.562	4275.56 SQM
26	38.44	37.00	38.00	2	57.0075	4275.562	4275.56 SQM
27	38.44	37.00	38.00	2	57.0075	4275.562	4275.56 SQM
28	38.44	37.00	38.00	2	57.0075	4275.562	4275.56 SQM
29	38.44	37.00	38.00	2	57.0075	4275.562	4275.56 SQM
30	38.44	37.00	38.00	2	57.0075	4275.562	4275.56 SQM
31	38.44	37.00	38.00	2	57.0075	4275.562	4275.56 SQM
32	38.44	37.00	38.00	2	57.0075	4275.562	4275.56 SQM
33	38.44	37.00	38.00	2	57.0075	4275.562	4275.56 SQM
34	38.44	37.00	38.00	2	57.0075	4275.562	4275.56 SQM
35	38.44	37.00	38.00	2	57.0075	4275.562	4275.56 SQM
36	38.44	37.00	38.00	2	57.0075	4275.562	4275.56 SQM
37	38.44	37.00	38.00	2	57.0075	4275.562	4275.56 SQM
38	38.44	37.00	38.00	2	57.0075	4275.562	4275.56 SQM
TOTAL							14028.214

NO	A	B	C	D	E	AREA OF + (S.C.)	Area
a	6	4.715	8.845			250.225	250.225 SQM
a1	1	4.715	8.730			41.162	41.162 SQM
a2	2	8.845	8.845			78.000	78.000 SQM
a3	3	8.845	8.845			78.000	78.000 SQM
a4	4	8.845	8.845			78.000	78.000 SQM
a5	5	8.845	8.845			78.000	78.000 SQM
a6	6	8.845	8.845			78.000	78.000 SQM
a7	7	8.845	8.845			78.000	78.000 SQM
a8	8	8.845	8.845			78.000	78.000 SQM
a9	9	8.845	8.845			78.000	78.000 SQM
a10	10	8.845	8.845			78.000	78.000 SQM
a11	11	8.845	8.845			78.000	78.000 SQM
a12	12	8.845	8.845			78.000	78.000 SQM
a13	13	8.845	8.845			78.000	78.000 SQM
a14	14	8.845	8.845			78.000	78.000 SQM
a15	15	8.845	8.845			78.000	78.000 SQM
a16	16	8.845	8.845			78.000	78.000 SQM
a17	17	8.845	8.845			78.000	78.000 SQM
a18	18	8.845	8.845			78.000	78.000 SQM
a19	19	8.845	8.845			78.000	78.000 SQM
a20	20	8.845	8.845			78.000	78.000 SQM
a21	21	8.845	8.845			78.000	78.000 SQM
a22	22	8.845	8.845			78.000	78.000 SQM
a23	23	8.845	8.845			78.000	78.000 SQM
a24	24	8.845	8.845			78.000	78.000 SQM
a25	25	8.845	8.845			78.000	78.000 SQM
a26	26	8.845	8.845			78.000	78.000 SQM
a27	27	8.845	8.845			78.000	78.000 SQM
a28	28	8.845	8.845			78.000	78.000 SQM
a29	29	8.845	8.845			78.000	78.000 SQM
a30	30	8.845	8.845			78.000	78.000 SQM
a31	31	8.845	8.845			78.000	78.000 SQM
a32	32	8.845	8.845			78.000	78.000 SQM
a33	33	8.845	8.845			78.000	78.000 SQM
a34	34	8.845	8.845			78.000	78.000 SQM
a35	35	8.845	8.845			78.000	78.000 SQM
a36	36	8.845	8.845			78.000	78.000 SQM
a37	37	8.845	8.845			78.000	78.000 SQM
a38	38	8.845	8.845			78.000	78.000 SQM
TOTAL							12495.813

TOTAL FAR AREA OF 7th to 9th, 11th to 13th, 15 & 16th FLOOR	=	GROSS - A	=	GROSS - B	=	14028.214	+ 12495.813	=	26524.027
TOTAL FAR AREA OF 7th to 9th, 11th to 13th, 15 & 16th FLOOR	=	GROSS - A	=	GROSS - B	=	14028.214	+ 12495.813	=	26524.027