

Note :-

1. BUILDING HAS AUTOMATIC SPRINKLER SYSTEM WHEREVER REQUIRED BY NBC.
2. BUILDING WILL BE DESIGNED (STRUCTURES) AS PER RELEVANT IS CODES FOR EARTH QUAKE RESISTANCE.
3. BUILDING IS ARTIFICIALLY LIGHTED MECHANICALLY VENTILATED & CENTRALLY AIRCONDITIONED WITH 100% POWER BACKUP

DLF48508

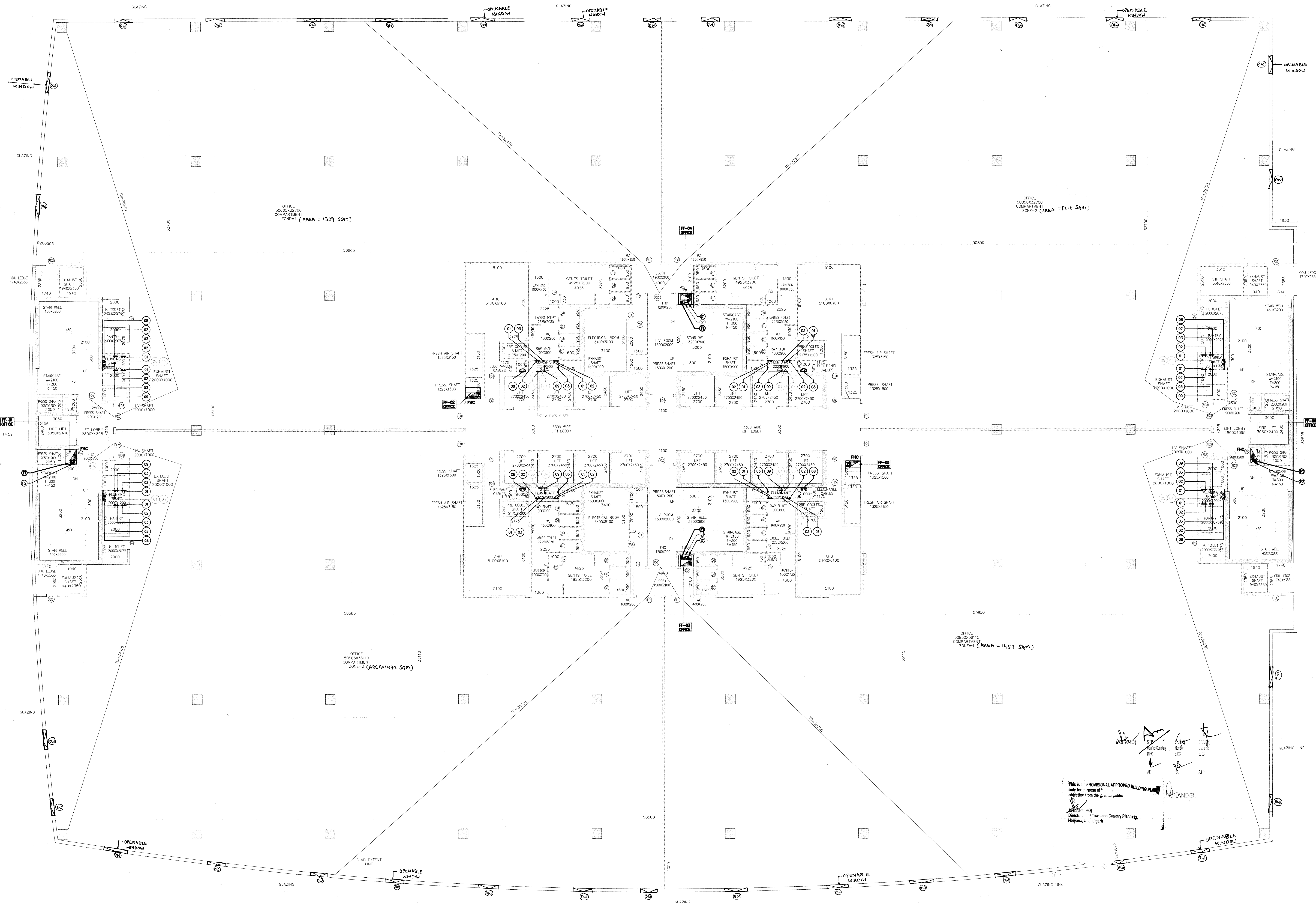

TYPICAL 3RD, 4TH, 5TH & 7TH, 8TH 9TH FLOOR PLAN BUILDING=2

NO.	FLOOR	LVL.
1	3RD	+13750
2	4TH	+17900
3	5TH	+22050
4	7TH	+30550
5	8TH	+34750
6	9TH	+38950

SR NO.	PARTICULARS	SIZE
D1	TOILET DOOR	750x2400
D2	JANITOR	800x2400
D3	PASSAGE	1000x2400
D4	FMC	900x2400
D5	ANU PASSAGE	1200x2400
D6	OFFICE ENTRANCE	2000x2400
D7	STAIRCASE/LIFT LOBBY	1700x2400
D8	LV. SHAFT	1000x2400
D9	ANU ROOM	1200x2400
D10	ELE. ROOM/LV. SHAFT	800x2400

- DOOR SCHEDULE
- 100mm SW PREPP
  - 100mm WATE PREPP
  - 75mm WENT PPE (PF)
  - 50mm SAFETY NETS
  - 100mm SW WATER PPE
  - 100mm SW WATER PPE
  - 100mm SWNT DRAIN PPE

This is a PROVISIONAL APPROVED BUILDING PLAN only for purpose of objection from the public. Checked: 11 Town and Country Planning, Haryana, Ludhiana.



RSMIS ARCHITECTS PVT. LTD.  
69, Nora Niwas Bhawani Kunj  
(Behind D2), Vasant Kunj,  
New Delhi-110070.  
Tel.: 011-26898616, 26898617  
www.rsmis-arch.com

Project:  
PROPOSED SUBMISSION OF UNDER TRANSIT ORIENTED DEVELOPMENT (TOD) POLICY FOR COMMERCIAL SITE MEASURING 32.36 ACRES FALLING IN RESIDENTIAL PLOTTED COLONY NAMEDLY DLF CITY, PHASE-I, II & III IN SECTOR-24, 25 & 25A GURUGRAM-MANESAR URBAN COMPLEX BEING DEVELOPED BY DLF LIMITED.

OWNER: DLF CITY CENTRE LTD.  
(THE SHOPPING MALL COMPLEX, ARJUN MARG, DLF CITY PHASE-I, GURGAON - 122002, HARYANA)

DRAWING TITLE: TYPICAL FLOOR PLAN (3rd, 4th, 5th, 7th, 8th, 9th) (View No. 02)  
Date: 22-08-2019

REVISION: NO. - , DRG. NO. B2-05, NORTH - N  
SCALE: 1/100, DATE: 22-08-2019  
FILE: OTO Director, Fire Service, Member, B.C. CHECKED BY: APPROVED BY:

