

Note :-

- BUILDING HAS AUTOMATIC SPRINKLER SYSTEM WHEREVER REQUIRED BY NBC.
- BUILDING WILL BE DESIGNED (STRUCTURES) AS PER RELEVANT CODES FOR EARTH QUAKE RESISTANCE.
- BUILDING IS ARTIFICIALLY LIGHTED MECHANICALLY VENTILATED & CENTRALLY AIRCONDITIONED WITH 100% POWER BACKUP

DLF48520

- PLUMBING LEGEND:
- 1000 SOIL PIPE (SP)
 - 1000 WASTE PIPE (WP)
 - 150 WASTE PIPE (WP)
 - 1000 PAN WATER PIPE
 - 1000 SHAF WATER PIPE
 - 1000 SHAF DRAIN PIPE

SR NO	PARTICULARS	SIZE	
D1	TOILET ROOM	750x400	
D2	JANITOR	900x2400	
D3	PASSAGE	1000x2400	
D4	PWC	900x2400	
D5	ANU PASSAGE	1000x2400	
F01	OFFICE ENTRANCE	2000x2400	2 HR
F02	STAIRCASE/LIFT LOBBY	1700x2400	2 HR
F03	LV SHAFT	1000x2400	2 HR
F04	ANU ROOM	1000x2400	2 HR
F05	ELE ROOM/LV SHAFT	900x2400	2 HR
OW	OPENABLE WINDOW	1480x2400	

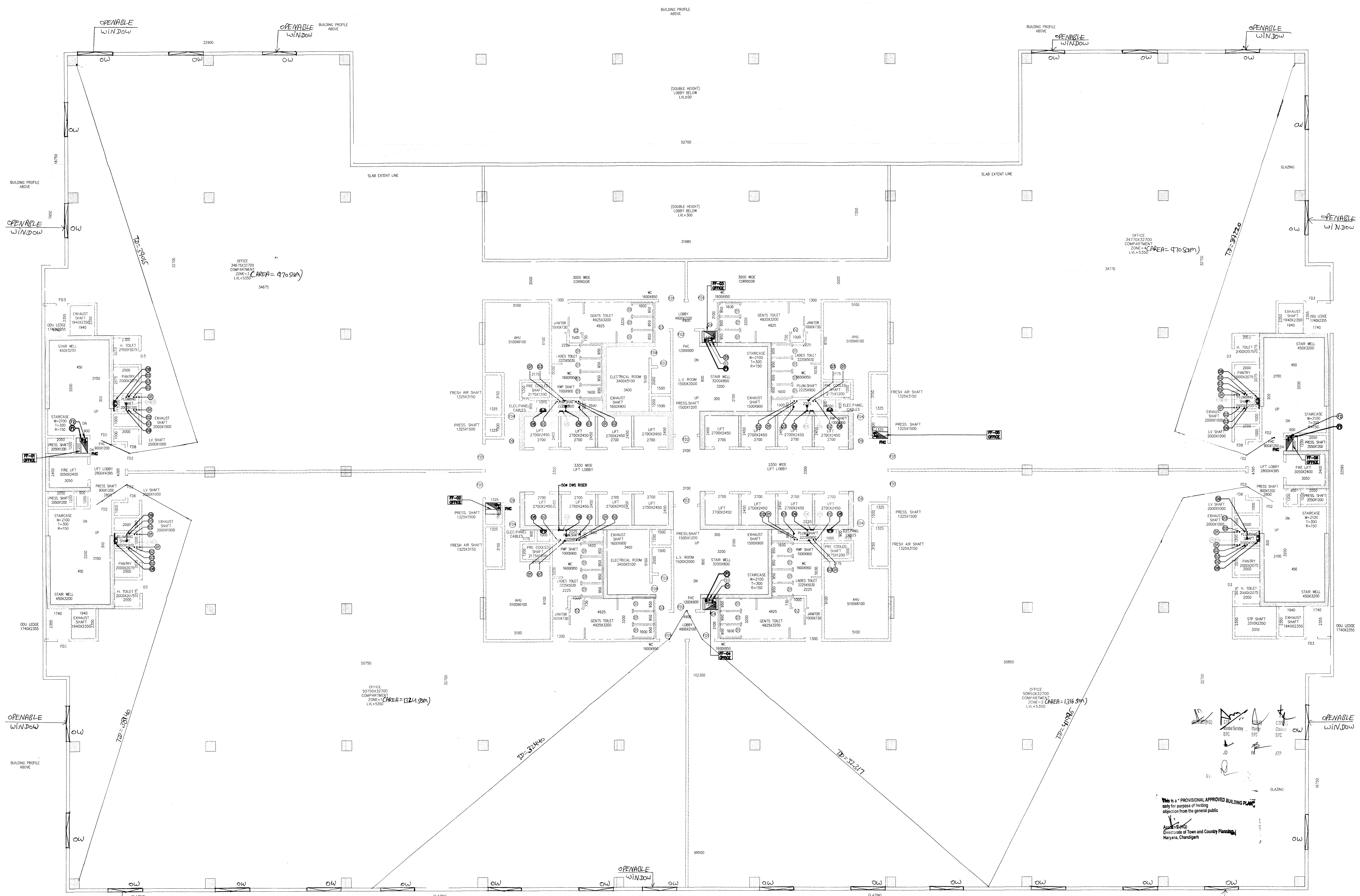

1ST FLOOR PLAN
LVL+5350
BUILDING=3

RISIMIS ARCHITECTS

RSMS ARCHITECTS PVT. LTD.
69, Nara Niwas Bhawanij Kunj
(Behind D2), Vasant Kunj,
New Delhi-110070.
Tel.: 011-26898616, 26898617
www.rsms-arch.com

Project:
PROPOSED SUBMISSION OF UNDER TRANSIT ORIENTED DEVELOPMENT (TOD) POLICY FOR COMMERCIAL SITE MEASURING 32.36 ACRES FALLING IN RESIDENTIAL PLOTTED COLONY NAMEDLY DLF CITY, PHASE-I, II & III IN SECTOR-24, 25 & 25A GURUGRAM-MANESAR URBAN COMPLEX BEING DEVELOPED BY DLF LIMITED.

OWNER: **DLF CITY CENTRE LTD.**
(THE SHOPPING MALL COMPLEX, ARJUN MARG, DLF CITY, PHASE-I, GOURGAND - 122002, HARYANA.)

DRAWING TITLE:-

Project: (BUILDING-03) **DLF** (Member B.F.C.)

REVISION JOB NO:- DRG NO. NORTH:-
SCALE:- DATE:-
1:100 22-08-2019

FILE:- DEALT BY:- CHECKED BY:- APPROVED BY:-

ARCHITECT'S SEAL & SIGNATURE OWNER'S SEAL & SIGNATURE

