

Note :-

- BUILDING HAS AUTOMATIC SPRINKLER SYSTEM WHEREVER REQUIRED BY NBC.
- BUILDING WILL BE DESIGNED (STRUCTURES) AS PER RELEVANT IS CODES FOR EARTH QUAKE RESISTANCE.
- BUILDING IS ARTIFICIALLY LIGHTED MECHANICALLY VENTILATED & CENTRALLY AIRCONDITIONED WITH 100% POWER BACKUP

DLF48521

- LEGEND:
- 100M SIZ. PIPE (P)
 - 100M WASTE PIPE (W)
 - 75M VENT PIPE (V)
 - 100M SUPPLY PIPE
 - 100M RAIN WATER PIPE
 - 100M SHUNT DRAIN PIPE

DOOR SCHEDULE	SIZE	FIRE RATING
SD10 PARTICULARS	750x2400	
E1 TOILET DOOR	900x2400	
E2 JANITOR	900x2400	
E3 PASSAGE	1000x2400	
E4 FIN	900x2400	
E9 AHU PASSAGE	1200x2400	
F01 OFFICE ENTRANCE	2000x2400	2 HR
F02 STAIRCASE/LIFT LOBBY	1700x2400	2 HR
F03 LV SHAFT	1000x2400	2 HR
E04 AHU ROOM	1200x2400	2 HR
F08 ELEC ROOM/LV SHAFT	900x2400	2 HR
OW OPENABLE WINDOW	1480x2160	

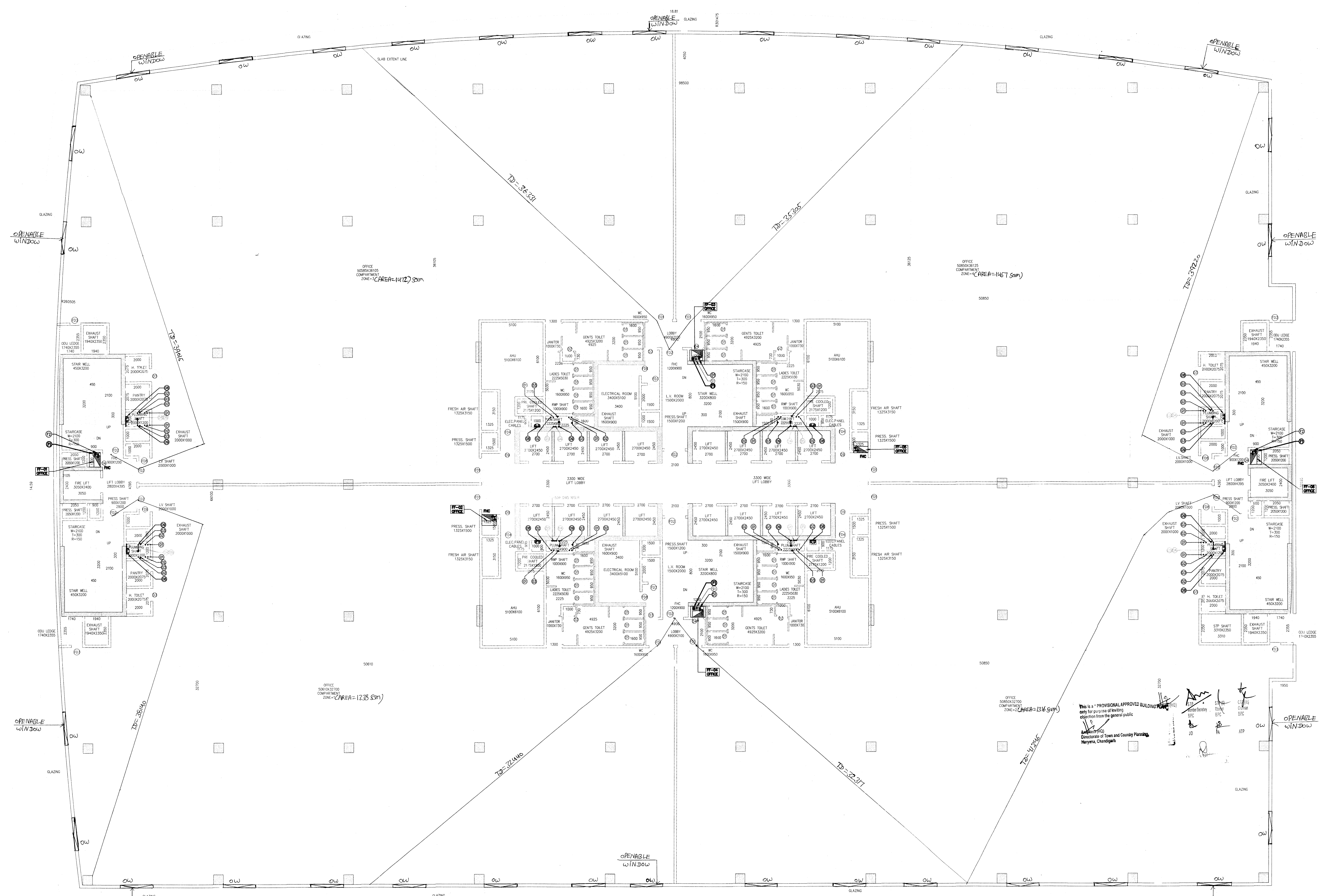

2ND FLOOR PLAN
LVL+9550
BUILDING=3



RIMS ARCHITECTS PVT. LTD.
69, Nara Niwas Bhawani Kunj
(Behind D2), Vasant Kunj,
New Delhi-110070.
Tel.: 011-26898616, 26898617
www.rims-arch.com

Project:
PROPOSED SUBMISSION OF UNDER TRANSIT ORIENTED DEVELOPMENT (TOD) POLICY FOR COMMERCIAL SITE MEASURING 32.36 ACRES FALLING IN RESIDENTIAL PLOTTED COLONY NAMEDLY DLF CITY PHASE-I, II & III IN SECTOR-24, 25 & 25A CURUGRAM-MANESAR URBAN COMPLEX BEING DEVELOPED BY DLF LIMITED.

OWNER: **DLF CITY CENTRE LTD.**
(THE SHOPPING MALL COMPLEX JARIN MANSAR DLF CITY PHASE-I JOURAGAN - 122002, HARYANA.)

DRAWING TITLE:-
2ND FLOOR PLAN (BUILDING-03)

REVISION: JOB NO. - DRG NO. - NORTH -
SCALE: - DATE: -
1:100 22-08-2019

FILE: - DEALT BY: - CHECKED BY: - APPROVED BY: -

ARCHITECT'S SEAL & SIGNATURE: OWNER'S SEAL & SIGNATURE:

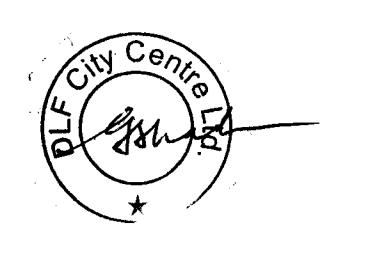
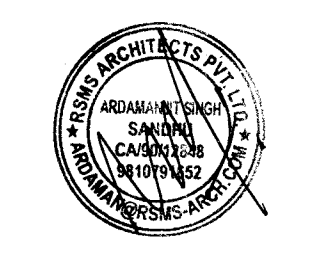

This is a PROVISIONAL APPROVED BUILDING PLAN only for purpose of having electricity connection from the general public.

Director of Town and Country Planning, Haryana, Chandigarh