

TO BE READ WITH THE OFFICE MEMO NO. / 1512 DATED: 14.12.2022

KEY PLAN

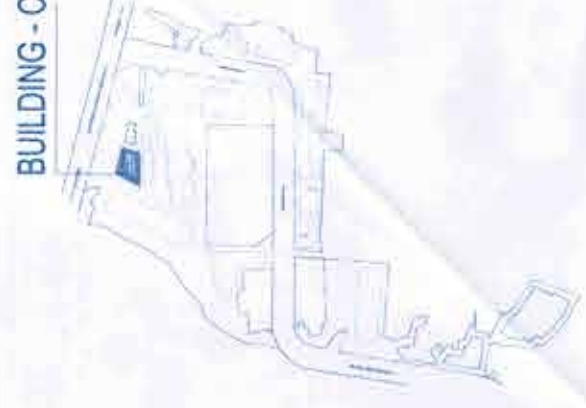

Architect
Hafeez

Contractor
RISIMIS ARCHITECTS

RISMS ARCHITECTS PVT. LTD.
#9 Narai Niwas, Bhawanji Kunj,
(Behind D2), Vasant Kunj,
New Delhi-110070
Tel: 011-26898616, 26898617
WWW.RISMS-ARCH.COM

PREPARED BUILDING PLANS OF BUILDING-C, D, E & F IN CYBER CITY UNDER TRANSIT ORIENTED DEVELOPMENT (TOD) POLICY FOR MIX-LAND-USE (COMMERCIAL/RESIDENTIAL/COMMERCIAL) MEASURING 108.65922 ACRES IN SECTOR 24, 25 & 25-A, GURUGRAM MANESAR URBAN COMPLEX BEING DEVELOPED BY DLF CYBER CITY DEVELOPERS LIMITED

OWNER: DLF Cyber City Developers Ltd.
10th Floor, DLF Gateway Tower,
DLF Cyber City, Gurugram, Haryana
Pin: 122102

DRAWING TITLE: AREA CALCULATION BASMENT 03 & 4 BLOCK-C

REVISION	DATE	BY	APPROVED BY
BS-6C	25-04-2022	[Signature]	[Signature]
SCALE: 1:200		DATE	APPROVED BY
		25-04-2022	OWNER'S SEAL & SIGNATURE
FILE NO.	DEALT BY	CHECKED BY	APPROVED BY
			[Signature]

BASMENT 03 AREA CALCULATION (BLOCK-C)

NO.	A	B	C	#	AREA OF -SIA-AS- (SIA-C)	Area
GROSS-A	1	X	31.000	X	50.020	1607.437
2	1.5	X	4.335	X	12.020	18.030
3	1.5	X	4.335	X	12.020	18.030
4	1.5	X	4.335	X	12.020	18.030
5	1.5	X	4.335	X	12.020	18.030
6	1.5	X	4.335	X	12.020	18.030
7	1.5	X	4.335	X	12.020	18.030
8	1.5	X	4.335	X	12.020	18.030
9	1.5	X	4.335	X	12.020	18.030
10	1.5	X	4.335	X	12.020	18.030
11	1.5	X	4.335	X	12.020	18.030
12	1.5	X	4.335	X	12.020	18.030
13	1.5	X	4.335	X	12.020	18.030
TOTAL						1635.467

DOUBLE HEIGHT/OUT AREA

NO.	A	B	C	#	AREA OF -SIA-AS- (SIA-C)	Area
GROSS-1	1	X	31.000	X	50.020	1607.437
2	1.5	X	4.335	X	12.020	18.030
3	1.5	X	4.335	X	12.020	18.030
4	1.5	X	4.335	X	12.020	18.030
5	1.5	X	4.335	X	12.020	18.030
6	1.5	X	4.335	X	12.020	18.030
7	1.5	X	4.335	X	12.020	18.030
8	1.5	X	4.335	X	12.020	18.030
9	1.5	X	4.335	X	12.020	18.030
10	1.5	X	4.335	X	12.020	18.030
11	1.5	X	4.335	X	12.020	18.030
12	1.5	X	4.335	X	12.020	18.030
13	1.5	X	4.335	X	12.020	18.030
TOTAL						1635.467

DOUBLE HEIGHT/OUT AREA

NO.	A	B	C	#	AREA OF -SIA-AS- (SIA-C)	Area
GROSS-2	1	X	31.000	X	50.020	1607.437
2	1.5	X	4.335	X	12.020	18.030
3	1.5	X	4.335	X	12.020	18.030
4	1.5	X	4.335	X	12.020	18.030
5	1.5	X	4.335	X	12.020	18.030
6	1.5	X	4.335	X	12.020	18.030
7	1.5	X	4.335	X	12.020	18.030
8	1.5	X	4.335	X	12.020	18.030
9	1.5	X	4.335	X	12.020	18.030
10	1.5	X	4.335	X	12.020	18.030
11	1.5	X	4.335	X	12.020	18.030
12	1.5	X	4.335	X	12.020	18.030
13	1.5	X	4.335	X	12.020	18.030
TOTAL						1635.467

BASMENT 04 AREA CALCULATION (BLOCK-C)

NO.	A	B	C	#	AREA OF -SIA-AS- (SIA-C)	Area
GROSS-A	1	X	31.000	X	50.020	1607.437
2	1.5	X	4.335	X	12.020	18.030
3	1.5	X	4.335	X	12.020	18.030
4	1.5	X	4.335	X	12.020	18.030
5	1.5	X	4.335	X	12.020	18.030
6	1.5	X	4.335	X	12.020	18.030
7	1.5	X	4.335	X	12.020	18.030
8	1.5	X	4.335	X	12.020	18.030
9	1.5	X	4.335	X	12.020	18.030
10	1.5	X	4.335	X	12.020	18.030
11	1.5	X	4.335	X	12.020	18.030
12	1.5	X	4.335	X	12.020	18.030
13	1.5	X	4.335	X	12.020	18.030
TOTAL						1635.467

DOUBLE HEIGHT/OUT AREA

NO.	A	B	C	#	AREA OF -SIA-AS- (SIA-C)	Area
GROSS-1	1	X	31.000	X	50.020	1607.437
2	1.5	X	4.335	X	12.020	18.030
3	1.5	X	4.335	X	12.020	18.030
4	1.5	X	4.335	X	12.020	18.030
5	1.5	X	4.335	X	12.020	18.030
6	1.5	X	4.335	X	12.020	18.030
7	1.5	X	4.335	X	12.020	18.030
8	1.5	X	4.335	X	12.020	18.030
9	1.5	X	4.335	X	12.020	18.030
10	1.5	X	4.335	X	12.020	18.030
11	1.5	X	4.335	X	12.020	18.030
12	1.5	X	4.335	X	12.020	18.030
13	1.5	X	4.335	X	12.020	18.030
TOTAL						1635.467

DOUBLE HEIGHT/OUT AREA

NO.	A	B	C	#	AREA OF -SIA-AS- (SIA-C)	Area
GROSS-2	1	X	31.000	X	50.020	1607.437
2	1.5	X	4.335	X	12.020	18.030
3	1.5	X	4.335	X	12.020	18.030
4	1.5	X	4.335	X	12.020	18.030
5	1.5	X	4.335	X	12.020	18.030
6	1.5	X	4.335	X	12.020	18.030
7	1.5	X	4.335	X	12.020	18.030
8	1.5	X	4.335	X	12.020	18.030
9	1.5	X	4.335	X	12.020	18.030
10	1.5	X	4.335	X	12.020	18.030
11	1.5	X	4.335	X	12.020	18.030
12	1.5	X	4.335	X	12.020	18.030
13	1.5	X	4.335	X	12.020	18.030
TOTAL						1635.467

