

NO.	MARK	DESCRIPTION
01	100	100 TO 200 PIPE
02	200	200 TO 300 PIPE
03	300	300 TO 400 PIPE
04	400	400 TO 500 PIPE
05	500	500 TO 600 PIPE
06	600	600 TO 700 PIPE
07	700	700 TO 800 PIPE
08	800	800 TO 900 PIPE
09	900	900 TO 1000 PIPE
10	1000	1000 TO 1100 PIPE
11	1100	1100 TO 1200 PIPE
12	1200	1200 TO 1300 PIPE
13	1300	1300 TO 1400 PIPE
14	1400	1400 TO 1500 PIPE
15	1500	1500 TO 1600 PIPE
16	1600	1600 TO 1700 PIPE
17	1700	1700 TO 1800 PIPE
18	1800	1800 TO 1900 PIPE
19	1900	1900 TO 2000 PIPE
20	2000	2000 TO 2100 PIPE
21	2100	2100 TO 2200 PIPE
22	2200	2200 TO 2300 PIPE
23	2300	2300 TO 2400 PIPE
24	2400	2400 TO 2500 PIPE
25	2500	2500 TO 2600 PIPE
26	2600	2600 TO 2700 PIPE
27	2700	2700 TO 2800 PIPE
28	2800	2800 TO 2900 PIPE
29	2900	2900 TO 3000 PIPE
30	3000	3000 TO 3100 PIPE
31	3100	3100 TO 3200 PIPE
32	3200	3200 TO 3300 PIPE
33	3300	3300 TO 3400 PIPE
34	3400	3400 TO 3500 PIPE
35	3500	3500 TO 3600 PIPE
36	3600	3600 TO 3700 PIPE
37	3700	3700 TO 3800 PIPE
38	3800	3800 TO 3900 PIPE
39	3900	3900 TO 4000 PIPE
40	4000	4000 TO 4100 PIPE
41	4100	4100 TO 4200 PIPE
42	4200	4200 TO 4300 PIPE
43	4300	4300 TO 4400 PIPE
44	4400	4400 TO 4500 PIPE
45	4500	4500 TO 4600 PIPE
46	4600	4600 TO 4700 PIPE
47	4700	4700 TO 4800 PIPE
48	4800	4800 TO 4900 PIPE
49	4900	4900 TO 5000 PIPE
50	5000	5000 TO 5100 PIPE
51	5100	5100 TO 5200 PIPE
52	5200	5200 TO 5300 PIPE
53	5300	5300 TO 5400 PIPE
54	5400	5400 TO 5500 PIPE
55	5500	5500 TO 5600 PIPE
56	5600	5600 TO 5700 PIPE
57	5700	5700 TO 5800 PIPE
58	5800	5800 TO 5900 PIPE
59	5900	5900 TO 6000 PIPE
60	6000	6000 TO 6100 PIPE
61	6100	6100 TO 6200 PIPE
62	6200	6200 TO 6300 PIPE
63	6300	6300 TO 6400 PIPE
64	6400	6400 TO 6500 PIPE
65	6500	6500 TO 6600 PIPE
66	6600	6600 TO 6700 PIPE
67	6700	6700 TO 6800 PIPE
68	6800	6800 TO 6900 PIPE
69	6900	6900 TO 7000 PIPE
70	7000	7000 TO 7100 PIPE
71	7100	7100 TO 7200 PIPE
72	7200	7200 TO 7300 PIPE
73	7300	7300 TO 7400 PIPE
74	7400	7400 TO 7500 PIPE
75	7500	7500 TO 7600 PIPE
76	7600	7600 TO 7700 PIPE
77	7700	7700 TO 7800 PIPE
78	7800	7800 TO 7900 PIPE
79	7900	7900 TO 8000 PIPE
80	8000	8000 TO 8100 PIPE
81	8100	8100 TO 8200 PIPE
82	8200	8200 TO 8300 PIPE
83	8300	8300 TO 8400 PIPE
84	8400	8400 TO 8500 PIPE
85	8500	8500 TO 8600 PIPE
86	8600	8600 TO 8700 PIPE
87	8700	8700 TO 8800 PIPE
88	8800	8800 TO 8900 PIPE
89	8900	8900 TO 9000 PIPE
90	9000	9000 TO 9100 PIPE
91	9100	9100 TO 9200 PIPE
92	9200	9200 TO 9300 PIPE
93	9300	9300 TO 9400 PIPE
94	9400	9400 TO 9500 PIPE
95	9500	9500 TO 9600 PIPE
96	9600	9600 TO 9700 PIPE
97	9700	9700 TO 9800 PIPE
98	9800	9800 TO 9900 PIPE
99	9900	9900 TO 10000 PIPE
100	10000	10000 TO 10100 PIPE

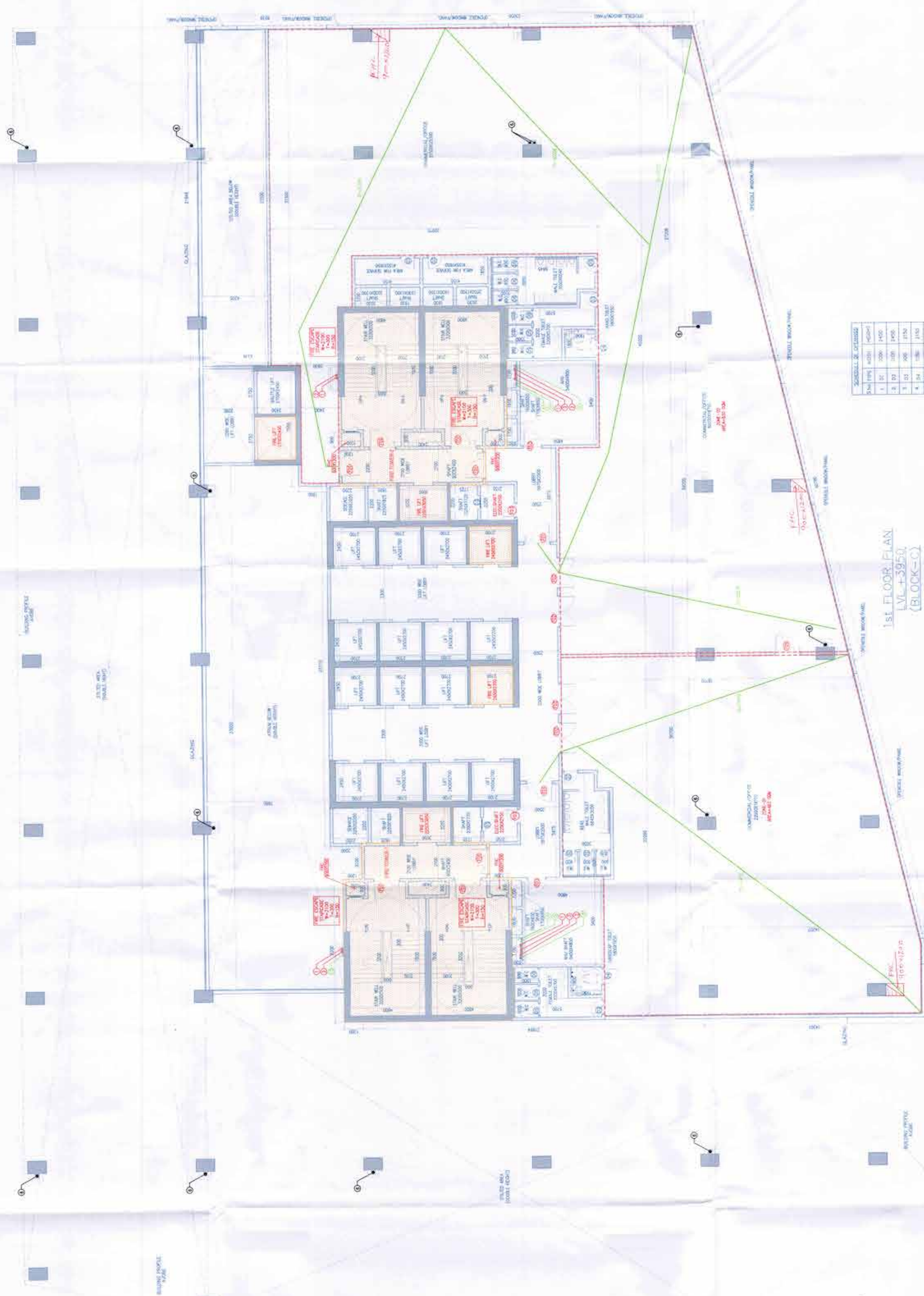

STAIRCASE NO.	WIDTH (MM)	LENGTH (MM)	AREA (SQ. MM)	PERF. PER FLOOR (MM)	TOTAL STAIRCASE WIDTH (MM)	TOTAL STAIRCASE LENGTH (MM)	TOTAL STAIRCASE AREA (SQ. MM)	TOTAL STAIRCASE PER FLOOR (MM)
1	1200	1400	1680000	1200	1200	1400	1680000	1200
2	1200	1400	1680000	1200	1200	1400	1680000	1200
3	1200	1400	1680000	1200	1200	1400	1680000	1200
4	1200	1400	1680000	1200	1200	1400	1680000	1200
5	1200	1400	1680000	1200	1200	1400	1680000	1200
6	1200	1400	1680000	1200	1200	1400	1680000	1200
7	1200	1400	1680000	1200	1200	1400	1680000	1200
8	1200	1400	1680000	1200	1200	1400	1680000	1200
9	1200	1400	1680000	1200	1200	1400	1680000	1200
10	1200	1400	1680000	1200	1200	1400	1680000	1200
11	1200	1400	1680000	1200	1200	1400	1680000	1200
12	1200	1400	1680000	1200	1200	1400	1680000	1200
13	1200	1400	1680000	1200	1200	1400	1680000	1200
14	1200	1400	1680000	1200	1200	1400	1680000	1200
15	1200	1400	1680000	1200	1200	1400	1680000	1200
16	1200	1400	1680000	1200	1200	1400	1680000	1200
17	1200	1400	1680000	1200	1200	1400	1680000	1200
18	1200	1400	1680000	1200	1200	1400	1680000	1200
19	1200	1400	1680000	1200	1200	1400	1680000	1200
20	1200	1400	1680000	1200	1200	1400	1680000	1200

1ST FLOOR PLAN
LEVEL +3950
(BLOCK-C)

NOTE:-ALL OPENABLE WINDOW / PANEL ARE PROVIDED AT 10M DISTANCE.

BLOCK NAME	FLOOR	AREA (SQ.M)	OCCUPANT LOAD	OCCUPANT LOAD PER FLOOR	TOTAL STAIRCASE WIDTH PER FLOOR	TOTAL STAIRCASE WIDTH REQUIRED	TOTAL STAIRCASE WIDTH PROVIDED	PROVIDED NO. OF STAIRCASES	REQUIRED NO. OF STAIRCASES
BLOCK-C	1ST FLOOR-OFFICE	208343	1 per 15 Sqm.	208	208	208	208	3	3

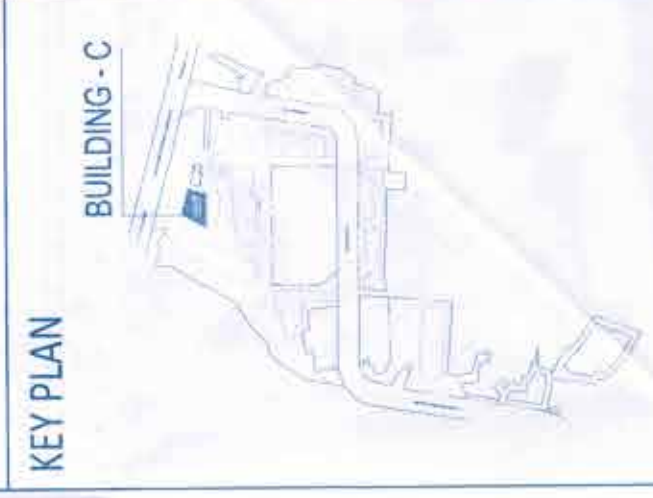

Architect
Hafeez
Contractor

RISIMIS
ARCHITECTS

RSMS ARCHITECTS PVT. LTD.
69, Nara Niwas, Bhawanil Kunj,
(Behind D2), Vasanti Kunj,
New Delhi-110070.
Tel: 011-26898016, 26898017
www.rsimis-arch.com

REVISOR: DLF Cyber City Developers Limited
OWNER: DLF Cyber City Developers Limited
10th Floor DLF Cybercity Tower,
DLF Cyber City Gurgaon, Gurgaon
Pin 122002

PROJECT: 10th Floor DLF Cybercity Tower,
DLF Cyber City Gurgaon, Gurgaon
Pin 122002

SCALE: 1:100
DATE: 25-04-2022

APPROVED BY: [Signature]
DRAWING TITLE: 1ST FLOOR PLAN
BLOCK-C

