

THIS IS A PRELIMINARY BUILDING PLAN  
 prepared for the purpose of providing  
 information to the general public.

Checked and found ok for Public Health  
 (Internal) Service only subject to comments in  
 forwarding letter No. 25/211/2022 dated 11/07/2022

Additional Chief Engineer  
 HVP, Panipat

DDTN MEMBER  
 BPAC  
 AD(HQ)

TO BE READ WITH THIS OFFICE  
 MEMO NO.: 1966/1  
 DATED: 11-07-2022

# GROUP HOUSING

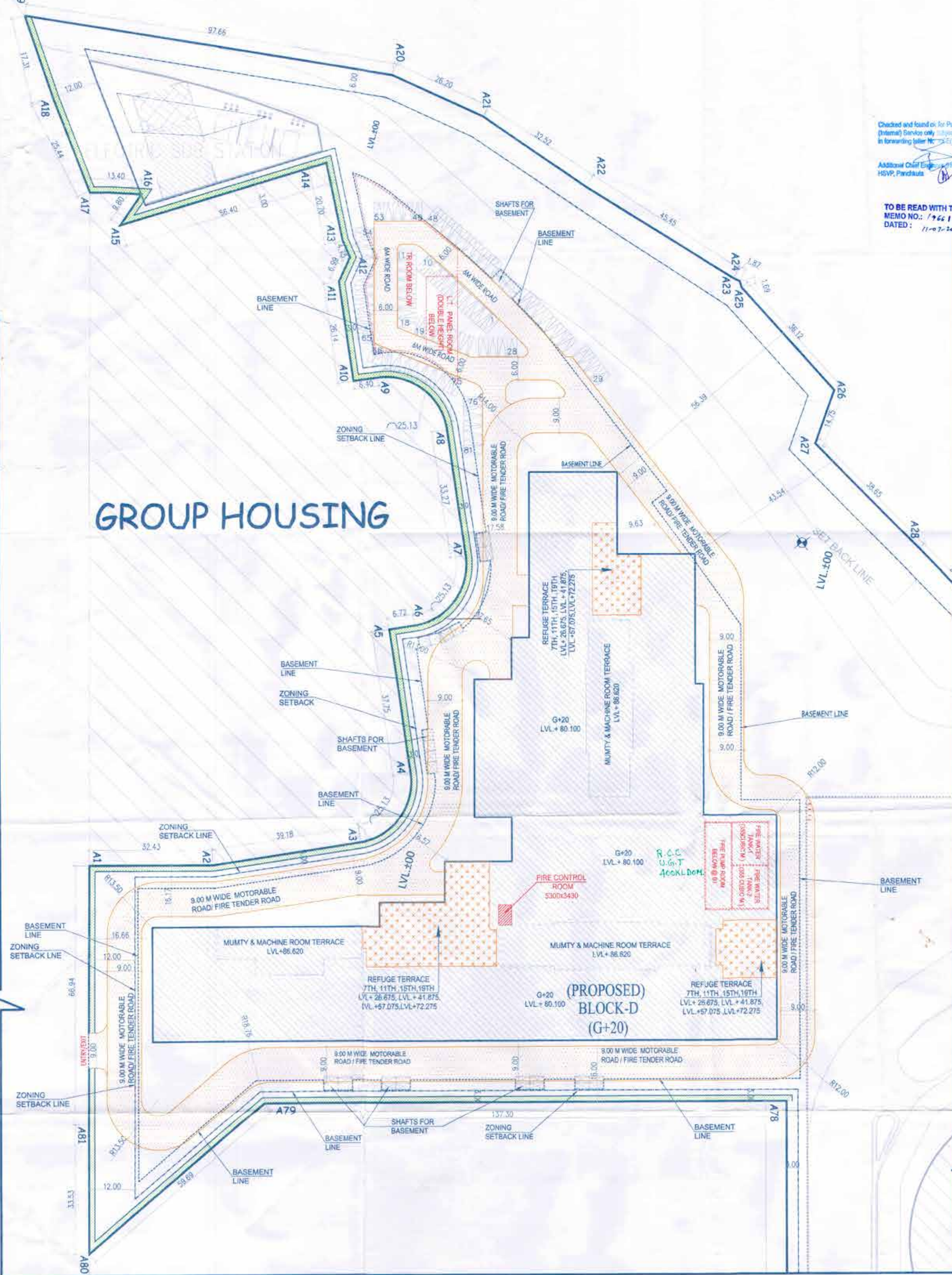

**Architect Hafeez Contractor**  
 29 Bar Street, Sonney 400 323, Tel: 2661920

**RSMS ARCHITECTS**

RSMS ARCHITECTS PVT. LTD.  
 69, Nara Niwas, Bhawani Kunj  
 (Behind D2), Vasant Kunj,  
 New Delhi - 110070  
 Tel: 011-26895616, 26895617  
 www.rsms-arch.com

Project:  
 REVISED BUILDING PLANS OF BUILDING-B, C, D,  
 E, & F IN CYBER CITY UNDER TRANSIT  
 ORIENTED DEVELOPMENT (TOD) POLICY FOR MIX  
 LAND USE (CO-DONOR 70% / 14% RES + 30%  
 COMMERCIAL) MEASURING 108.55922 ACRES IN  
 SECTOR 24, 25 & 25-A, GURUGRAM MANESAR  
 URBAN COMPLEX BEING DEVELOPED BY  
 DLF CYBER CITY DEVELOPERS LIMITED.

OWNER:  
**DLF** Cyber City Developers Ltd.  
 10th Floor DLF Gateway Tower,  
 DLF Cyber City, Gurgaon,  
 Haryana. Pin: 122002

DRAWING TITLE: BLOCK-D SITE PLAN

REVISION	JOB NO.	DRG NO.
		BDST-01
	SCALE: 1:500	DATE: 05-04-2022

FILE: REALTY BY: CHECKED BY: APPROVED BY:

ARCHITECT'S SEAL & SIGNATURE: OWNER'S SEAL & SIGNATURE:

BLOCK	USAGE	FLOOR	NO OF FLOORS	FAR/FLOOR WISE	TOTAL FAR/FLOOR WISE	FAR -IT/ COMMERCIAL	TOTAL FAR -IT/ COMMERCIAL	NON FAR AREA	GROUND COVERAGE	BUILTUP AREA
BLOCK-D	COMMERCIAL	GROUND FLOOR	1	7891.316	7891.316			3495.604	11378.820	11378.820
		1st FLOOR	1	1473.392	5413.392					5413.392
		2nd FLOOR	1	9134.843	10134.843					10134.843
		3rd FLOOR	1	9134.843	10134.843					10134.843
		4th FLOOR	1	9134.843	10134.843					10134.843
		5th FLOOR	1	9134.843	10134.843					10134.843
	ITITES	7TH REFUGE FLOOR	1	1070.617	8445.008					8445.008
		REFUGE TERRACE IN FAR	1	474.491						474.491
		8th FLOOR	1	9134.843	10134.843					10134.843
		9th FLOOR	1	9134.843	10134.843					10134.843
		10th FLOOR	1	9134.843	10134.843					10134.843
		11TH REFUGE FLOOR	1	1070.617	8445.008					8445.008
		REFUGE TERRACE IN FAR	1	474.491						474.491
		12th FLOOR	1	10134.843	10134.843					10134.843
13th FLOOR	1	10134.843	10134.843			10134.843				
14th FLOOR	1	10134.843	10134.843			10134.843				
15th REFUGE FLOOR	1	1070.617	8445.008			8445.008				
REFUGE TERRACE IN FAR	1	474.491				474.491				
16th FLOOR	1	10134.843	10134.843			10134.843				
17th FLOOR	1	10134.843	10134.843			10134.843				
18th FLOOR	1	10134.843	10134.843			10134.843				
19th REFUGE FLOOR	1	1070.617	8445.008			8445.008				
REFUGE TERRACE IN FAR	1	474.491				474.491				
20th FLOOR	1	10134.843	10134.843			10134.843				
MUMTY/MACHINE ROOM	1						1540.891			
BASEMENT	BASEMENT-1	1					20091.024			
	BASEMENT-2	1					15400.674			
	BASEMENT-3	1					18893.677			
	BASEMENT-4	1								
<b>TOTAL</b>				202193.588	202193.588				293798.162	

BASIS	FLOOR	NO OF FLOORS	NET AREA OF BASEMENT	SERVICE AREA	NET PARKING AREA	BLOCK-D		ECS PROVIDED	ECS PROVIDED	TOTAL ECS
						ECS CAPACITY	TYPE OF ECS			
BASEMENT	BASEMENT-1	1	19243.597	2666.060	16577.537	518	DOUBLE STACK	384X2	768	3163
	BASEMENT-2	1	20091.024	3499.587	16591.437	518	DOUBLE STACK	384X2	768	
	BASEMENT-3	1	18490.674	2261.772	16228.902	507	DOUBLE STACK	384X2	768	
	BASEMENT-4	1	19993.677	3690.526	16303.151	509	DOUBLE STACK	389X2	778	
						1 ECS @ 32 SQM.	SURFACE	81	81	