

This is a "PROVISIONAL BUILDING PLAN" and is subject to any objections from the concerned public.

DRG NO. BE-04A

11/11/2021
 11/11/2021
 11/11/2021
 11/11/2021
 11/11/2021

11/11/2021
 11/11/2021
 11/11/2021
 11/11/2021
 11/11/2021

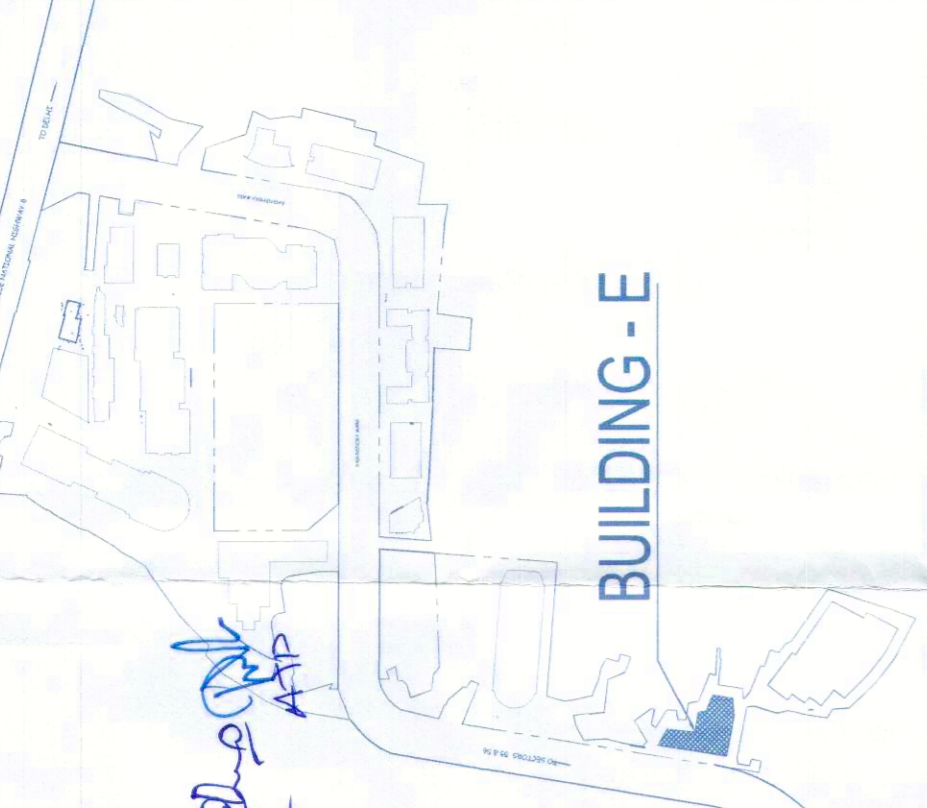

KEY PLAN

Architect
Hafeez Contractor
 29 Bala Street, Borey 403, Teluk Anson

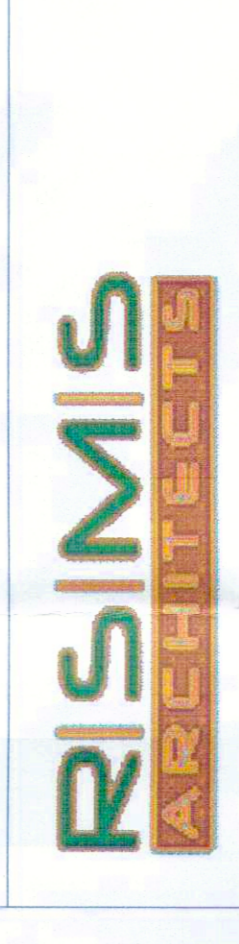

RSMS ARCHITECTS PVT. LTD.
 69, Kara Nivas, Bhawan Kunj
 (Behind D2), Vasant Kunj,
 New Delhi-110070.
 Tel: 011-2688616, 26898617
 www.rsms-grch.com

Project:
 PROPOSED BUILDING PLANS OF
 BUILDING - B AND REVISED PLANS
 OF BUILDING - C, D, E, & F IN CYBER CITY
 UNDER TRANSIT ORIENTED DEVELOPMENT
 (TOD) POLICY FOR MIX LAND USED
 COLONY (20% IT/TIES / 4.30% COMMERCIAL)
 MEASURING 108.55922 ACRES IN SECTOR 24,
 25 & 25-A, GURUGRAM MANESAR URBAN
 COMPLEX BEING DEVELOPED BY
 DLF CYBER CITY DEVELOPERS LIMITED

OWNER:
DLF
 DLF Cyber City Developers Ltd.
 10th Floor DLF Gateway Tower,
 DLF Cyber City, Gurugram, Haryana
 Pin: 122002

DRAWING TITLE: INTERIOR PLAN BLOCK-E

REVISION	JOB NO. -	DRG NO. -	DATE -	APPROVED BY -
		BE-04A	24-04-2021	
FILE -	SCALE -	CHECKED BY -	OWNER'S SEAL & SIGNATURE	
	1:100			

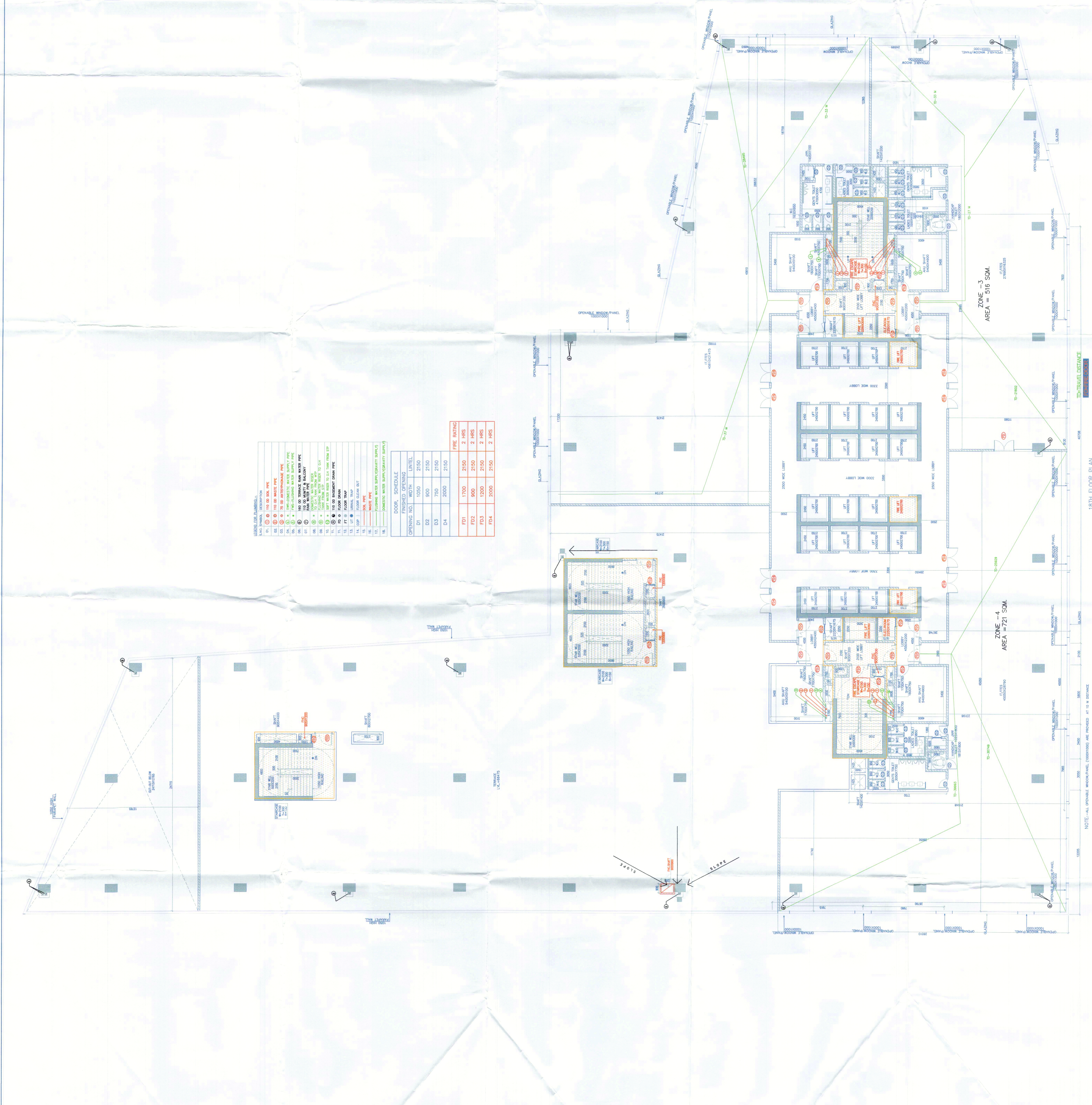

LEVELS, FINISHES, SCHEDULES

01	01	100	100	100	100	100	100	100
02	02	100	100	100	100	100	100	100
03	03	100	100	100	100	100	100	100
04	04	100	100	100	100	100	100	100
05	05	100	100	100	100	100	100	100
06	06	100	100	100	100	100	100	100
07	07	100	100	100	100	100	100	100
08	08	100	100	100	100	100	100	100
09	09	100	100	100	100	100	100	100
10	10	100	100	100	100	100	100	100
11	11	100	100	100	100	100	100	100
12	12	100	100	100	100	100	100	100
13	13	100	100	100	100	100	100	100
14	14	100	100	100	100	100	100	100
15	15	100	100	100	100	100	100	100
16	16	100	100	100	100	100	100	100
17	17	100	100	100	100	100	100	100
18	18	100	100	100	100	100	100	100

DOOR SCHEDULE

DOOR NO.	WIDTH	HGT	FINISH	REMARKS
D1	1050	2150	100	
D2	900	2150	100	
D3	750	2150	100	
D4	2000	2150	100	

FIRE RATING

FIRE NO.	WIDTH	HGT	REMARKS
F01	1700	2150	2 HRS
F02	900	2150	2 HRS
F03	1200	2150	2 HRS
F04	2000	2150	2 HRS

18TH FLOOR PLAN
 U1-188412

NOTE: ALL OPENABLE WINDOW PANELS (INDICATED) ARE PROVIDED AT 1/8" SLOPE